



RAILFLEX MANUEL D'INSTALLATION





RAILFLEX STORAGE

The best solution for maximising commercial space from floor to ceiling is Railflex. Specially designed by our team for light storage duties, Railflex shelves also allow you to store your heaviest items. Our HD system is more robust and meets the highest safety standards. Whether fixed or mobile, Railflex structures adapt to all types of spaces, even narrow ones, such as back stores and archive rooms. Both models, whether used together or separately, make your entire space more cost effective. The shelves can be installed at different heights allowing you to change the configuration at any time.

INDUSTRIAL FRAME

Material: Painted steel 18GA

Standard Dimensions:

Depth: 12"- 14"- 15"- 16"- 18"- 22"- 24"

Height: de 60" - 144" in increments of 12"

Side reinforcements are riveted.
Closed sides also available

HD posts: 11GA painted steel with double front impact reinforcements

INDUSTRIAL SHELF

Material: Painted steel 22 GA

Standard Dimensions:

Depth: 12"- 14"- 15"- 16"- 18"- 22"- 24"

- Width: 36", 42", 48" *Other dimensions available on demand

- Capacity: 400 pounds with uniformly distributed load. Double load capacity with HD system.

CARRIAGE

Material: galvanized steel

Standard Dimensions: 24"- 28"- 30"- 32"- 36"- 44" 48"

Depth: 36", 48", 72", 84", 96"

- Foot brake & 2 anti-tilt brackets on all mobile sections

- Capacity: 1200 pounds per mobile section



COMPONENTS

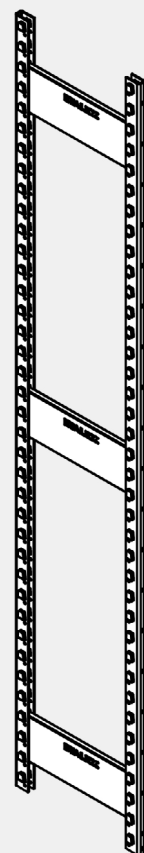

SQUARE NUT 1/4

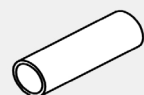

SPACER

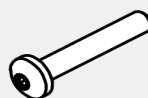

ROUND HEAD SQUARE

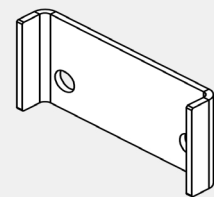

ANTI-FLIP BASE

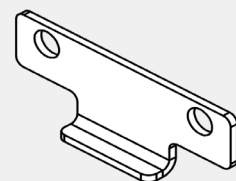

ANTI-FLIP HOOK

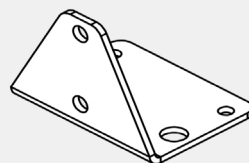

BASE PLATE

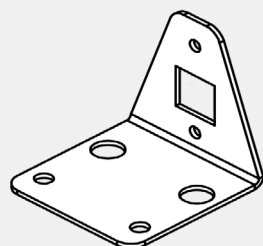

L" BASE PLATE

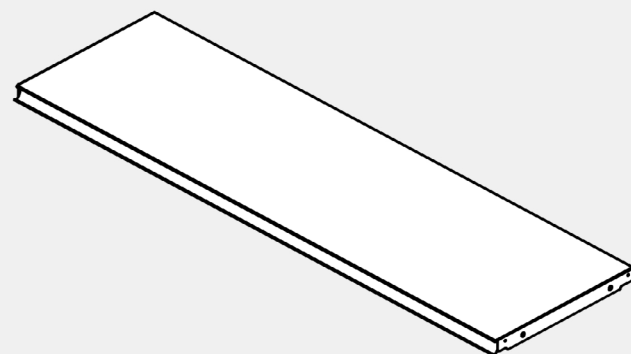

INDUSTRIAL SHELF

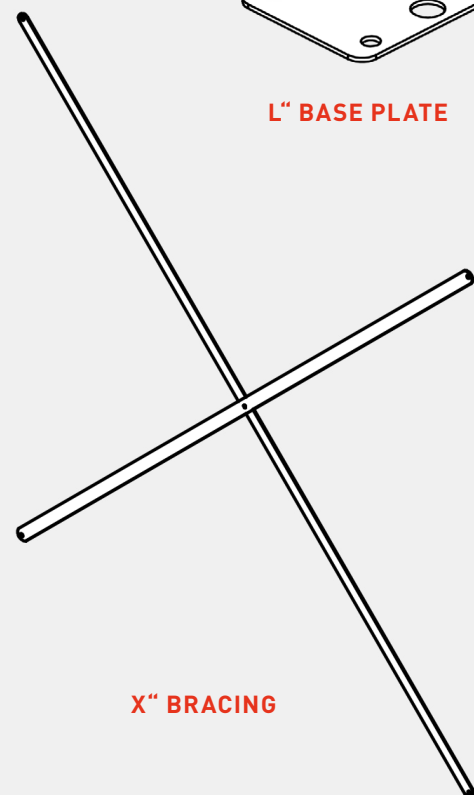

X" BRACING

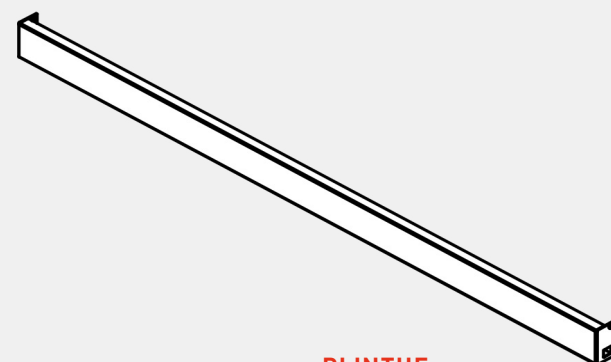

PLINTHE INDUSTRIEL

FIXED UNIT ASSEMBLY

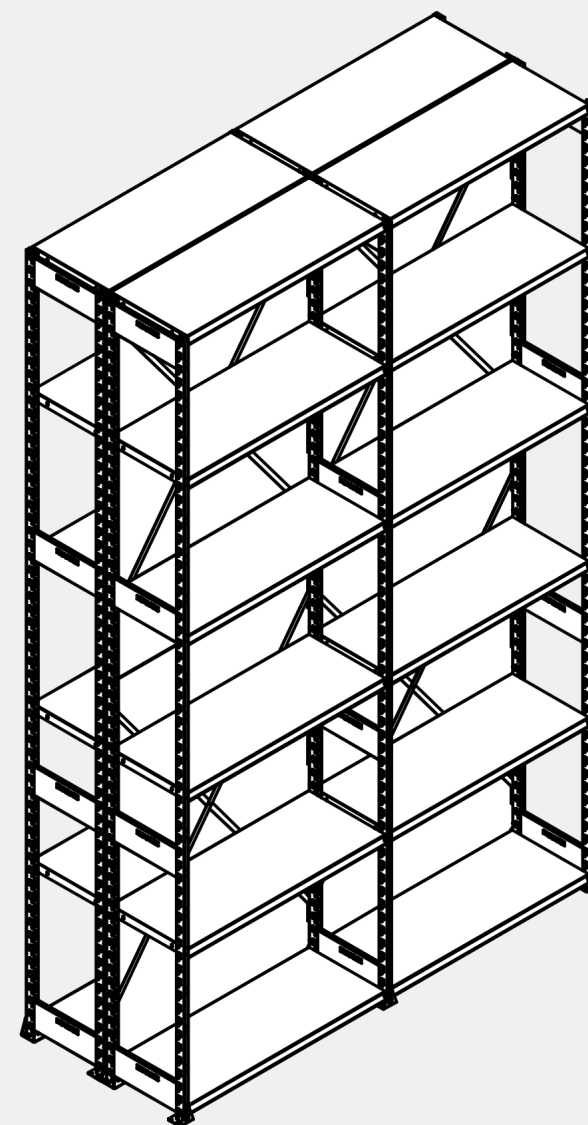

FREESTANDING DOUBLE UNIT

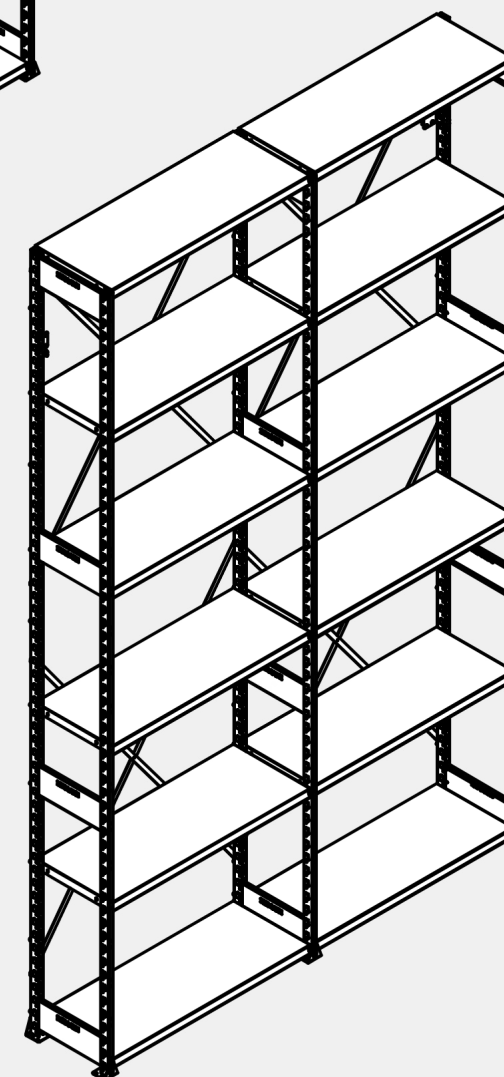

WALL UNIT

ETALEX



FIXED UNIT ASSEMBLY

INSTALL BASE PLATES ON THE UPRIGHTS.

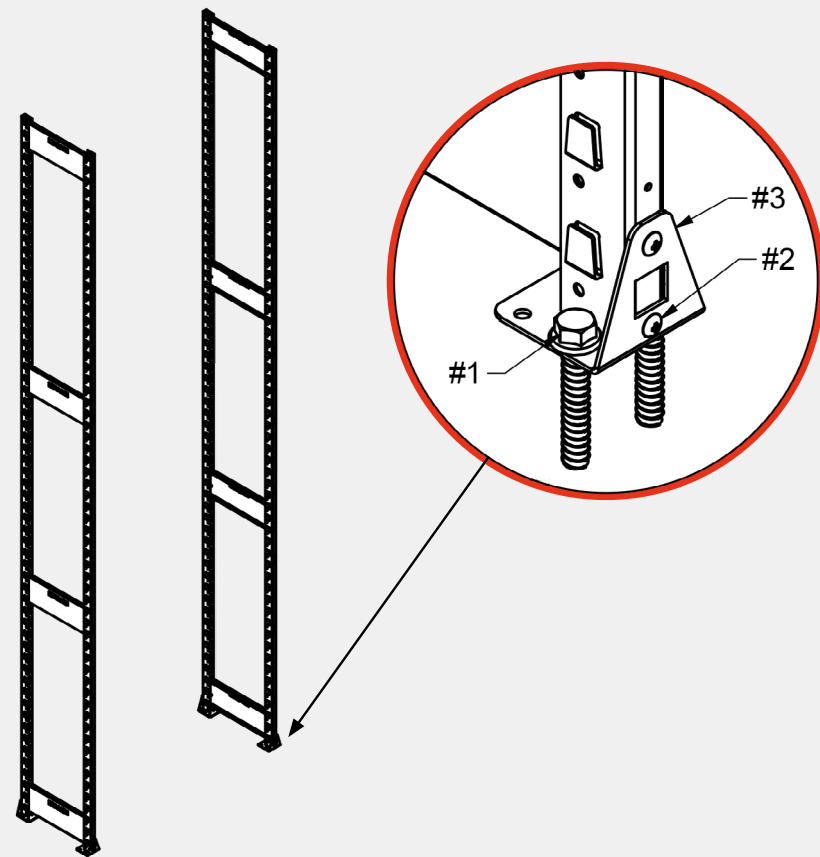

INSTALL THE TOP, BOTTOM AND MIDDLE SHELVING ON THE UPRIGHTS.

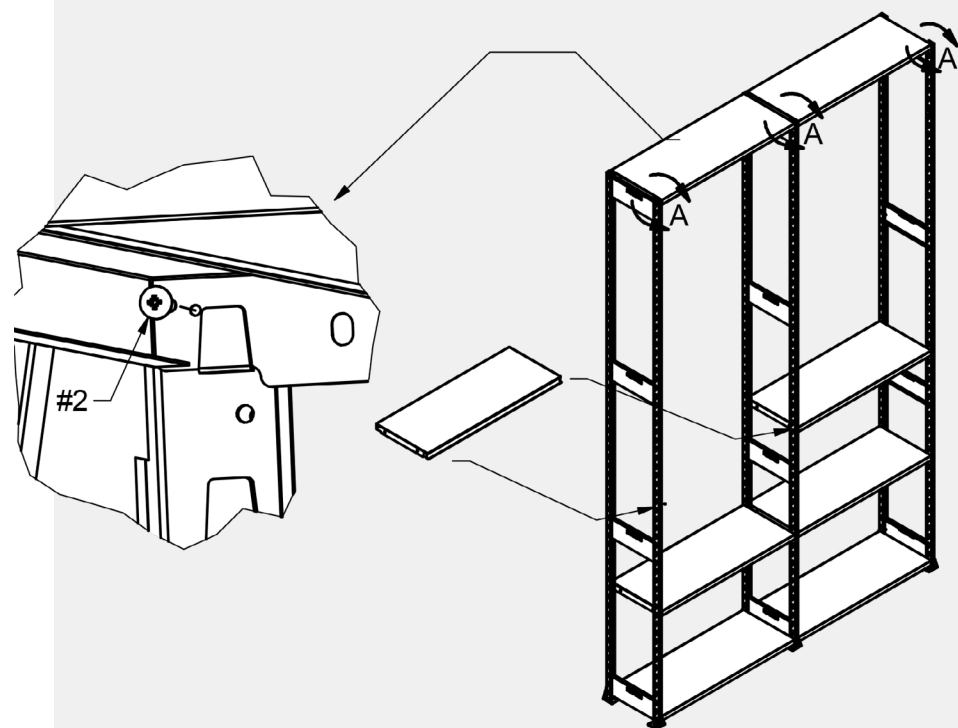

IMPORTANT:
SCREW THE
TOP SHELF
ONLY

FIXED UNIT ASSEMBLY

INSTALL BRACING IN THE BACK POSITION BY HEIGHT.
(SEE CHART)

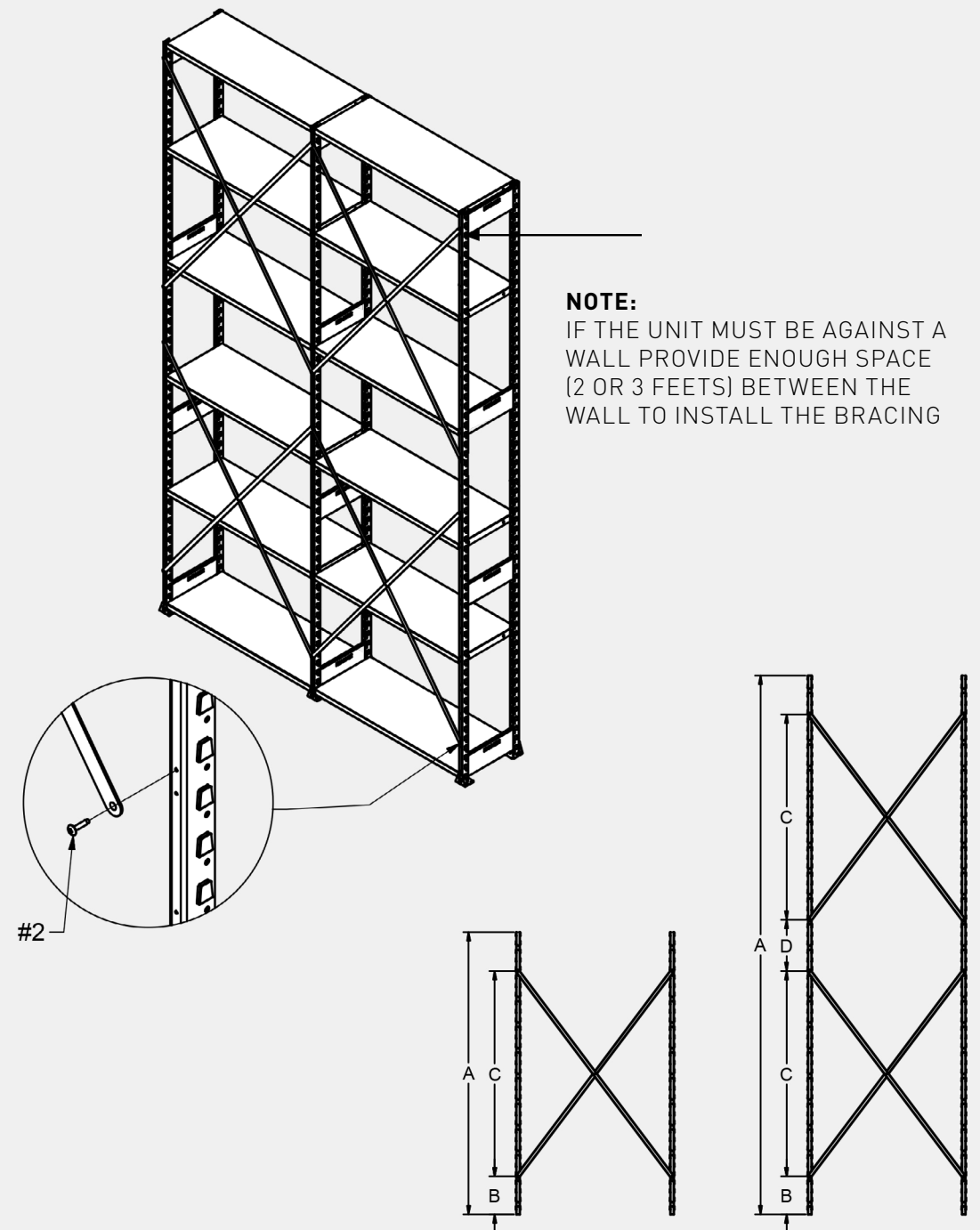

NOTE:
IF THE UNIT MUST BE AGAINST A
WALL PROVIDE ENOUGH SPACE
(2 OR 3 FEET) BETWEEN THE
WALL TO INSTALL THE BRACING

A - HAUTEUR	B - DIM	C - DIM	D - DIM	QTY - CROISILLON
36"	1 13/16"	30"	-	1
48"	1 13/16"	30"	-	1
60"	7 13/16"	48"	-	1
72"	7 13/16"	48"	-	1
84"	7 13/16"	48"	-	1
96"	7 13/16"	48"	-	1
102"	7 13/16"	48"	-	1
108"	7 13/16"	48"	-	1
120"	7 13/16"	48"	12"	2
132"	7 13/16"	48"	12"	2
144"	7 13/16"	48"	12"	2

ETALEX

FIXED UNIT ASSEMBLY

INSTALL BACKING PANEL IF REQUIRED.

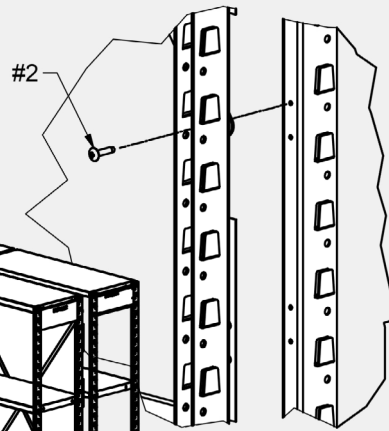
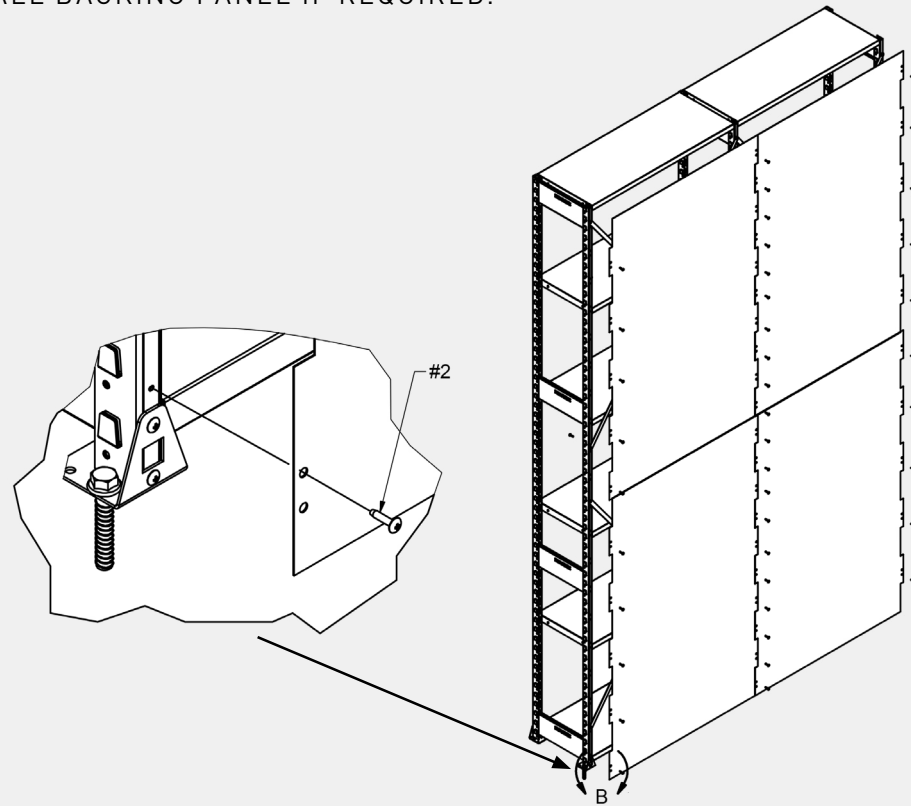

DETAIL C

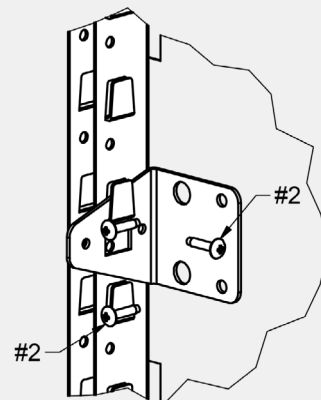

DETAIL D

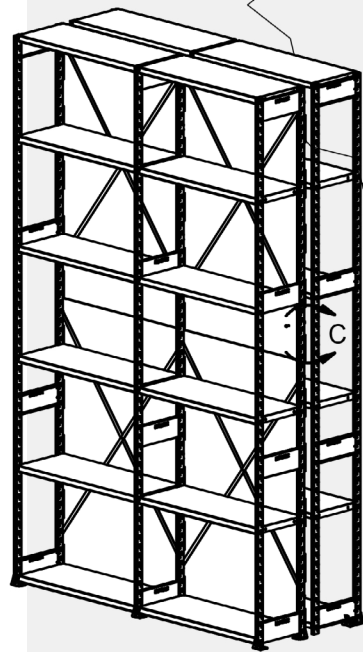

FREESTANDING DOUBLE UNIT:
INSTALL BOTH UNIT TOGETHER BACK TO BACK WITH SELF TAPPING SCREW.

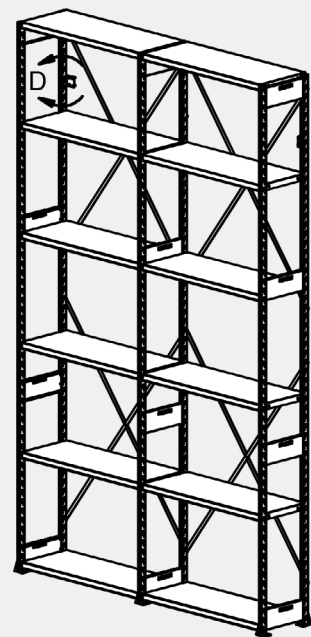

WALL UNIT:
INSERT THE BASE PLATE AT HORIZONTAL IN THE SLOT TO ATTACH UNIT TO THE WALL

FIXED UNIT ASSEMBLY

INSTALL RAILS ON THE FLOOR
(FOLLOW THE LAYOUT FOR POSITIONNING CENTER/CENTER).

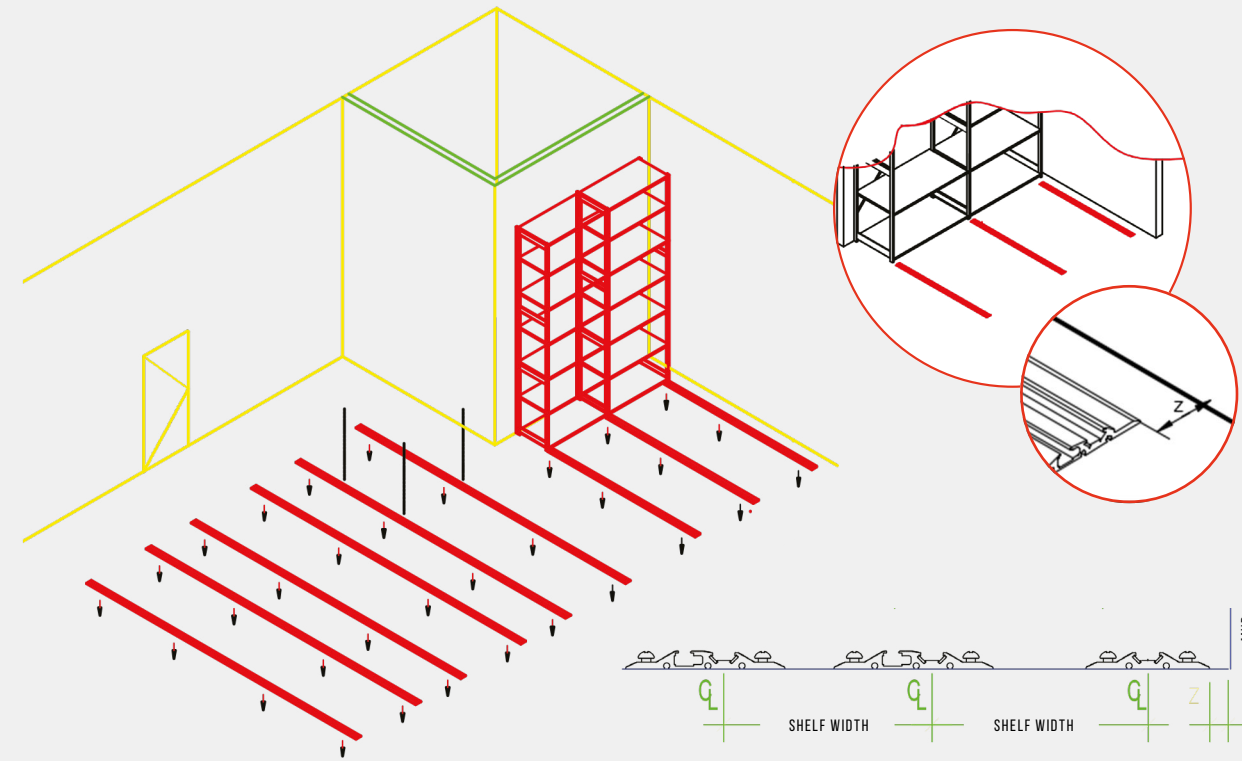

ITEM #	DIM	X	Y	Z
8R51	36"	36"	-	1"
8R53	48"	48"	-	1"
8R54	72"	36"	36"	1"
8R55	84"	48"	36"	1"
8R56	96"	48"	48"	1"

1/4" X 2 1/2" NAIL ANCHOR

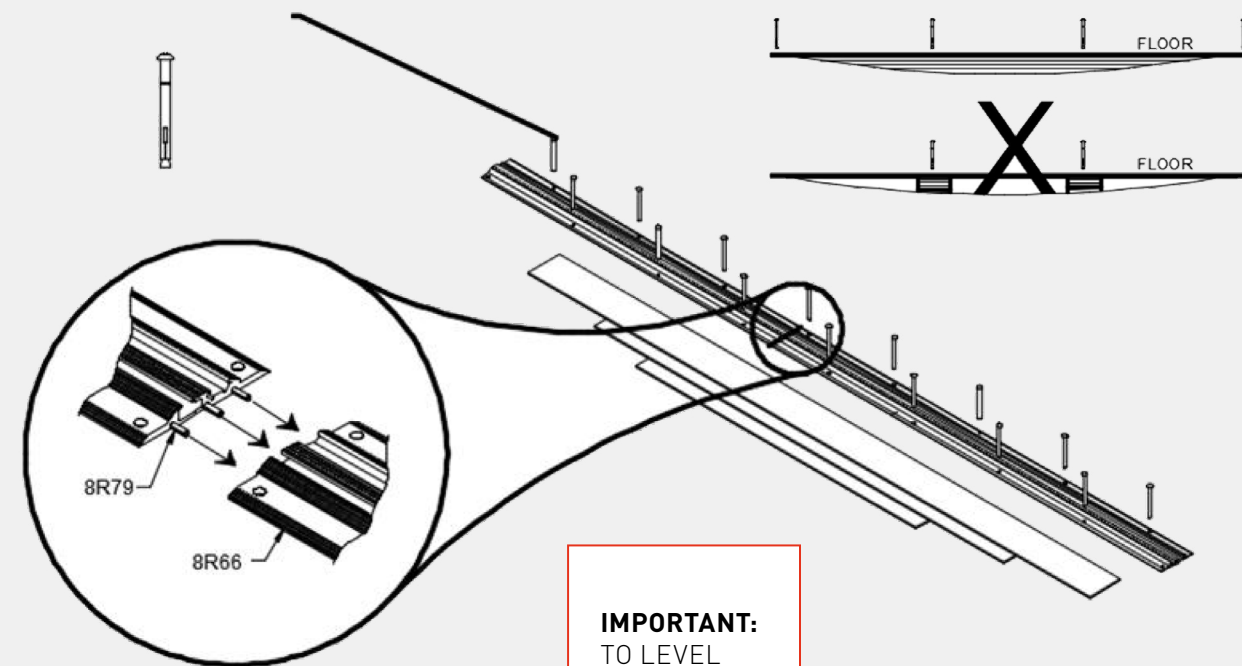

IMPORTANT:
TO LEVEL

RAILFLEX

MOBILE UNIT ASSEMBLY

APPLY CAULKING ON ALL SHIM EXPOSED FACES TO AVOID CONTACT WITH WATER.

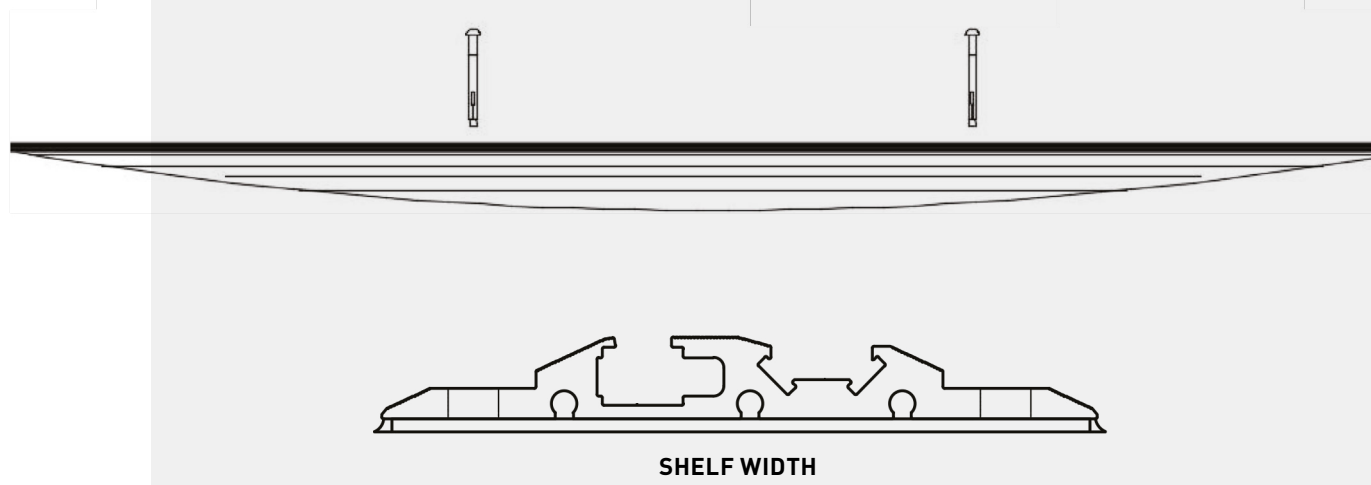

MOBILE UNIT ASSEMBLY

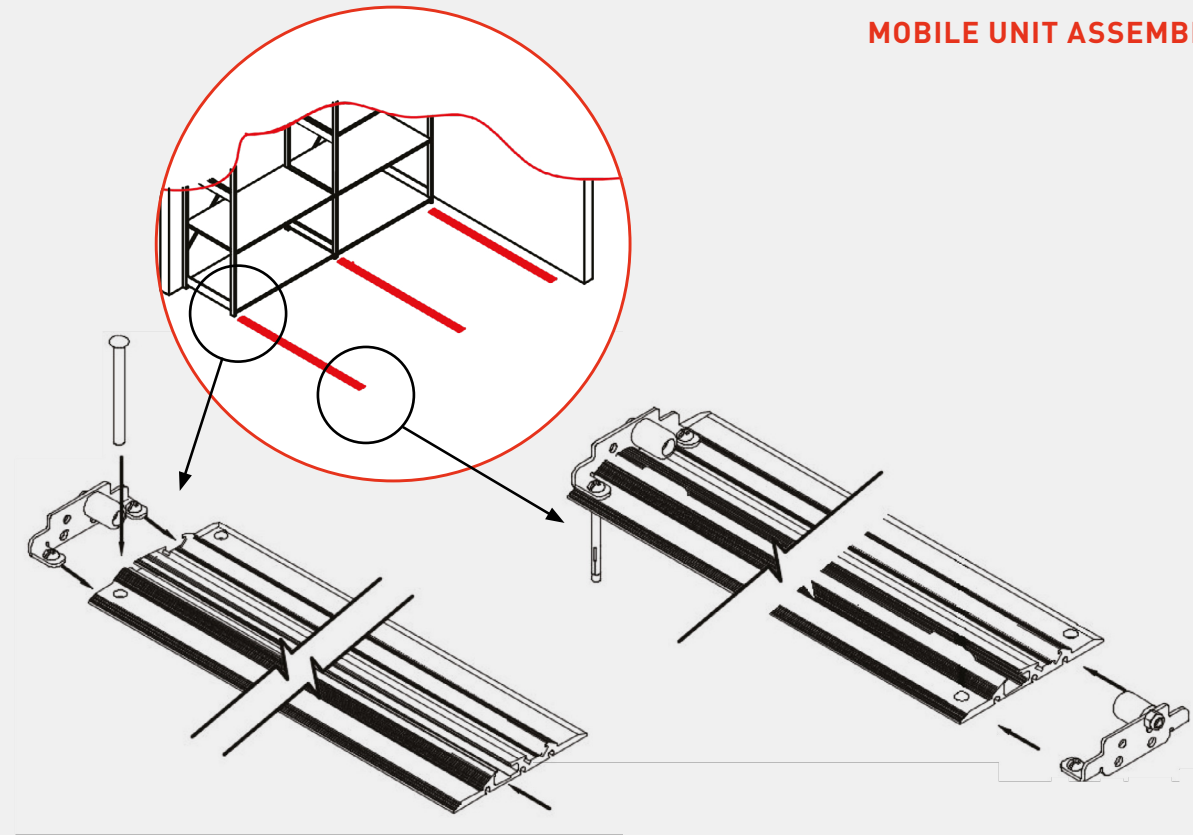

CARRIAGE CHARIOT
36" - 42" - 48"

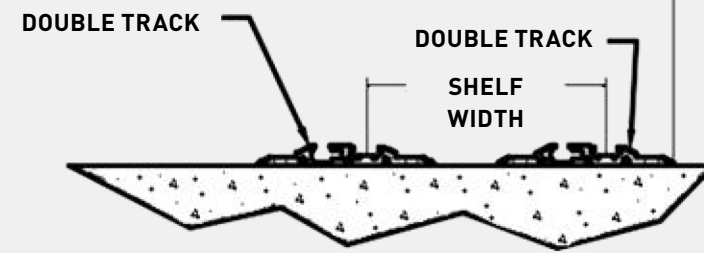

CARRIAGE CHARIOT
60" - 72" - 84" - 96"

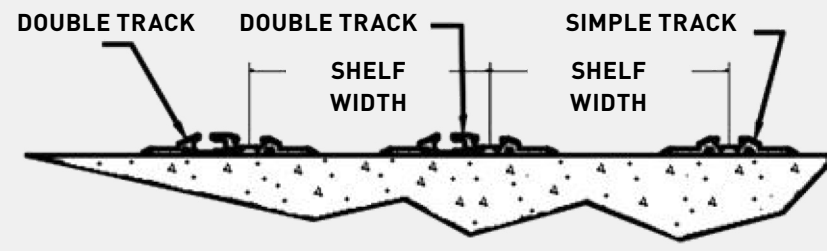

CARRIAGE CHARIOT
108"

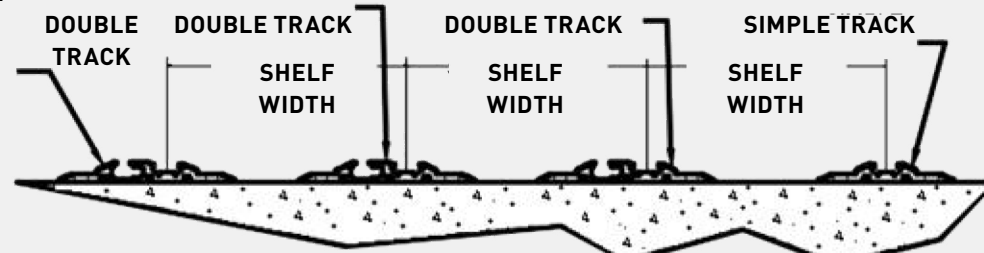

INSTALL ANTI-TIP ON THE CENTER TRACK FOR CARRIAGE 60", 72", 84", 96" AND ON THE RAIL CLOSER TO THE WALL FOR 36" AND 48".

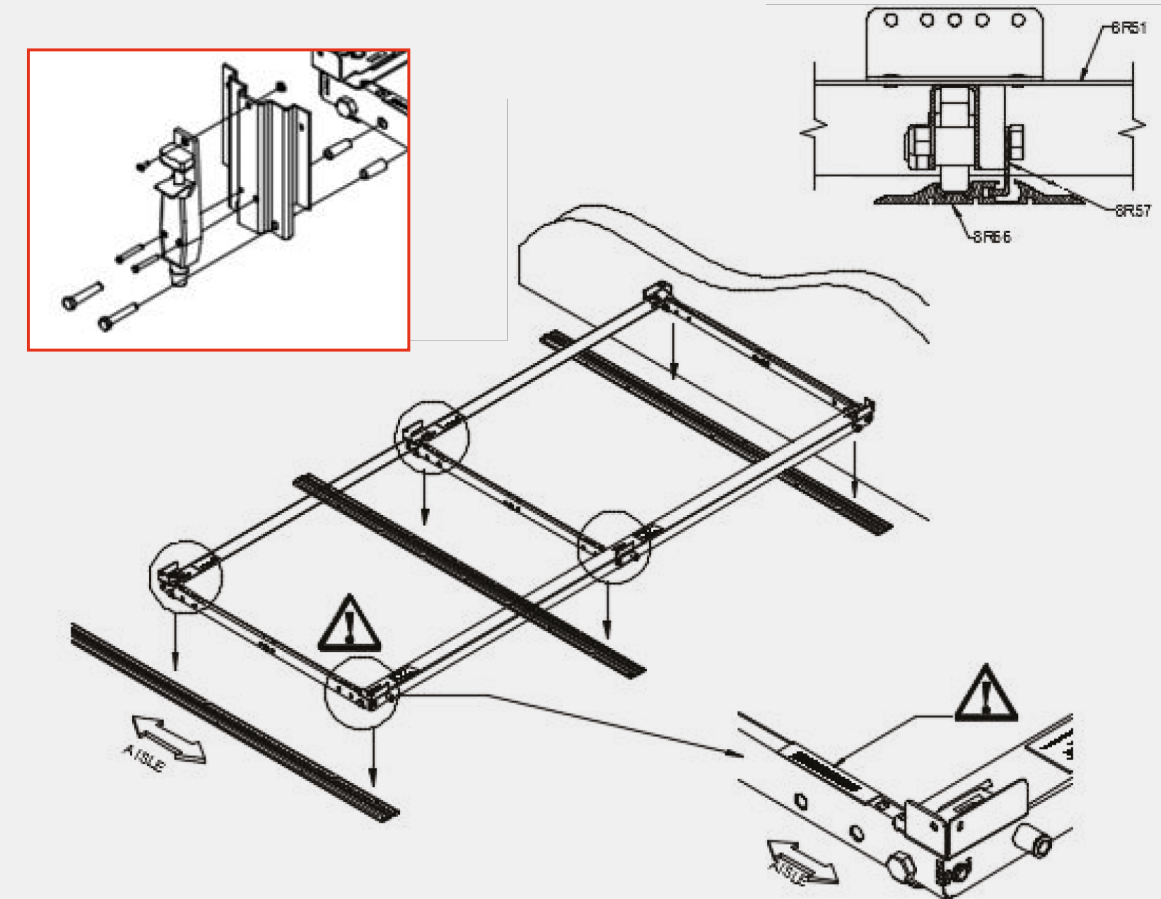

ETALEX

MOBILE UNIT ASSEMBLY

DEPOSIT THE TROLLEY ON THE RAILS.
LOCK THE TROLLEY IN PLACE WITH THE ANTI-FLIP TIE.

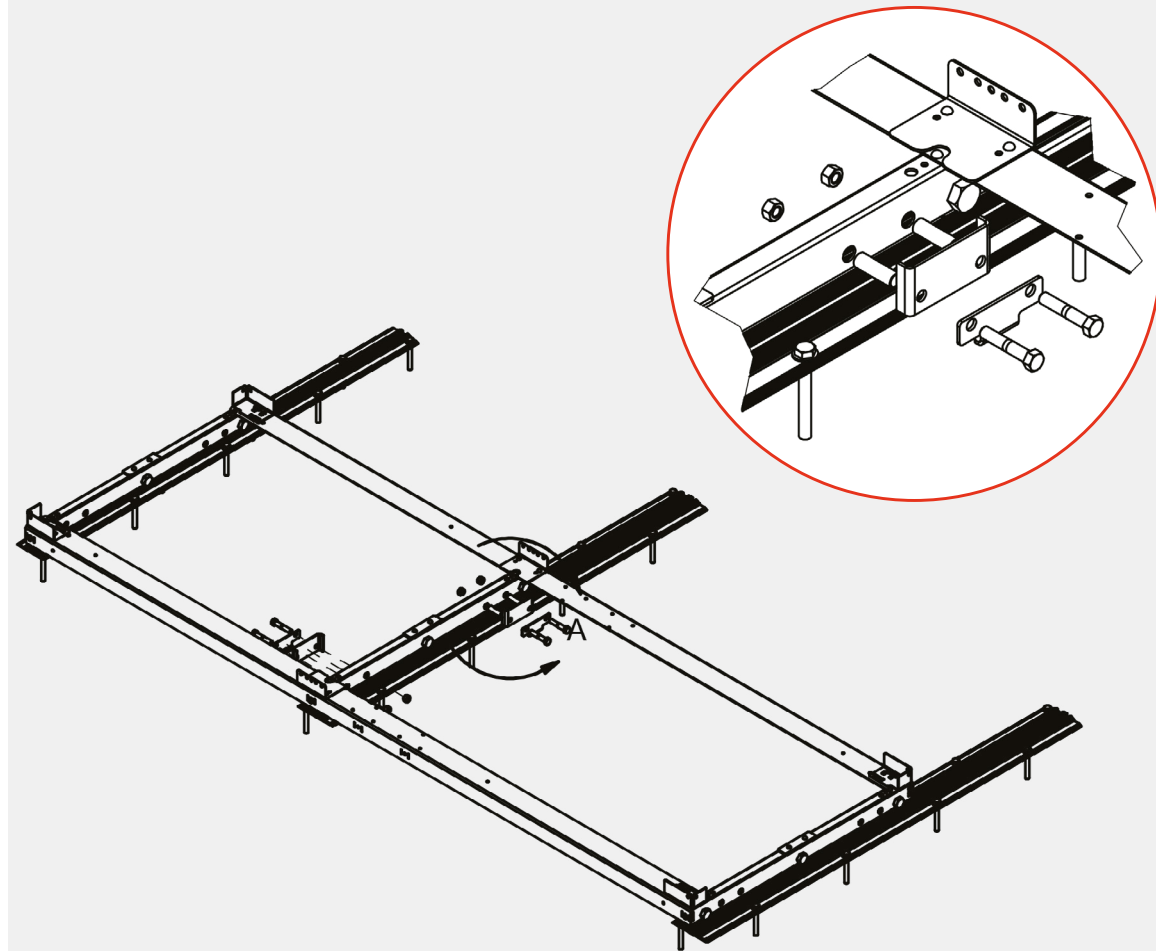

NOTE:
DEPOSIT CASTERS ON THE INSIDE OF
THE RAILS TO LEAVE THE REQUIRED
SPACE FOR THE BRAKE.

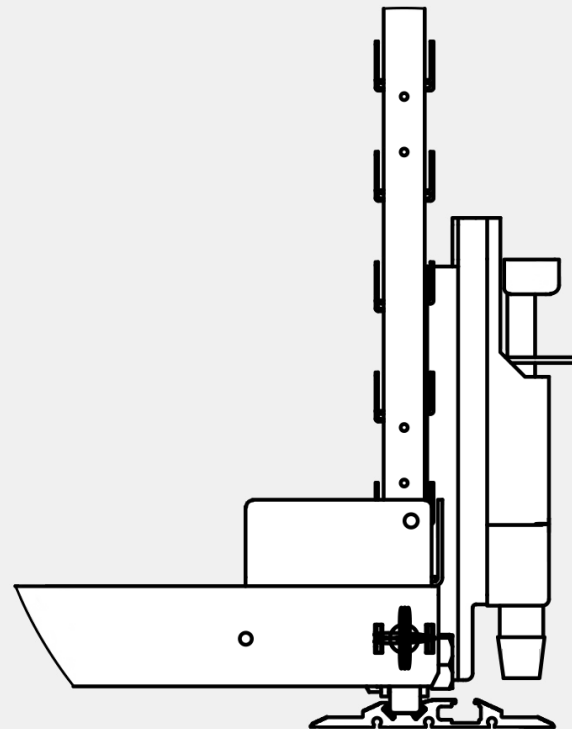

MOBILE UNIT ASSEMBLY

INSTALL THE TOP, BOTTOM AND MIDDLE SHELVING ON THE UPRIGHTS.

IMPORTANT:
INSERT
SHELVES IN
THE SLOTS
AND SCREW
THE TOP
SHELF ONLY.

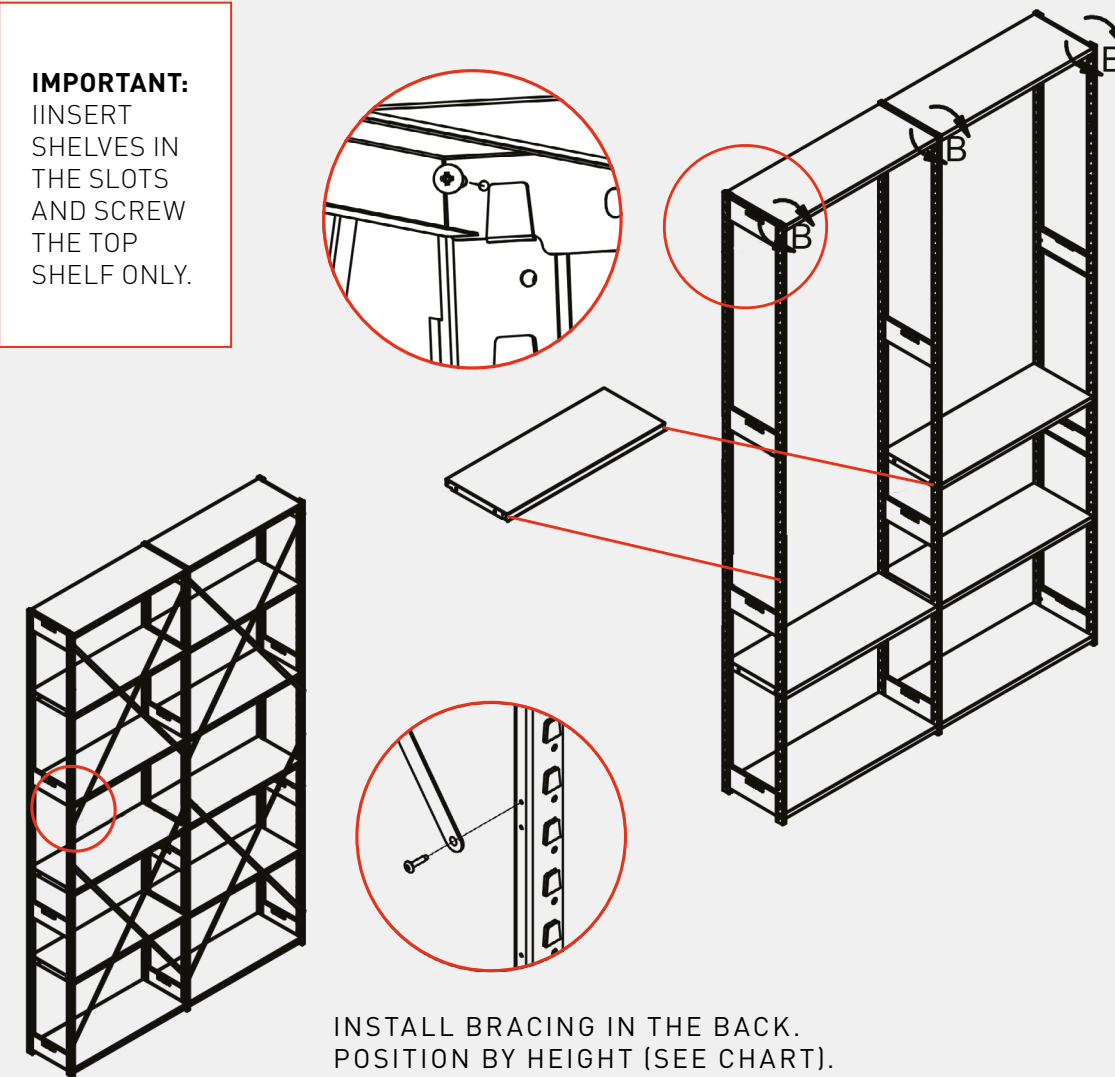

INSTALL BRACING IN THE BACK.
POSITION BY HEIGHT (SEE CHART).

A HEIGHT	B DIM	C DIM	D DIM	QTY DE CROISILLON
36"	1 13/16"	30"	-	1
48"	1 13/16"	30"	-	1
60"	7 13/16"	48"	-	1
72"	7 13/16"	48"	-	1
84"	7 13/16"	48"	-	1
96"	7 13/16"	48"	-	1
102"	7 13/16"	48"	-	1
108"	7 13/16"	48"	-	1
120"	7 13/16"	48"	12"	2
132"	7 13/16"	48"	12"	2
144"	7 13/16"	48"	12"	2

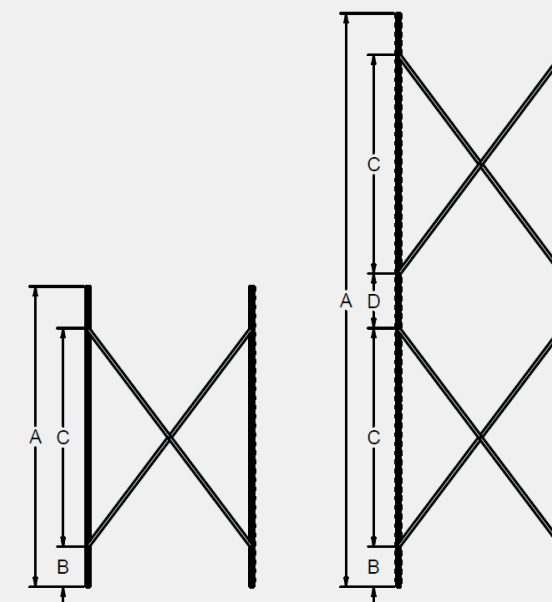

INSTALL BACKING PANEL IF REQUIRED.

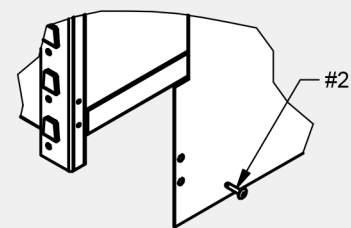

DETAIL C

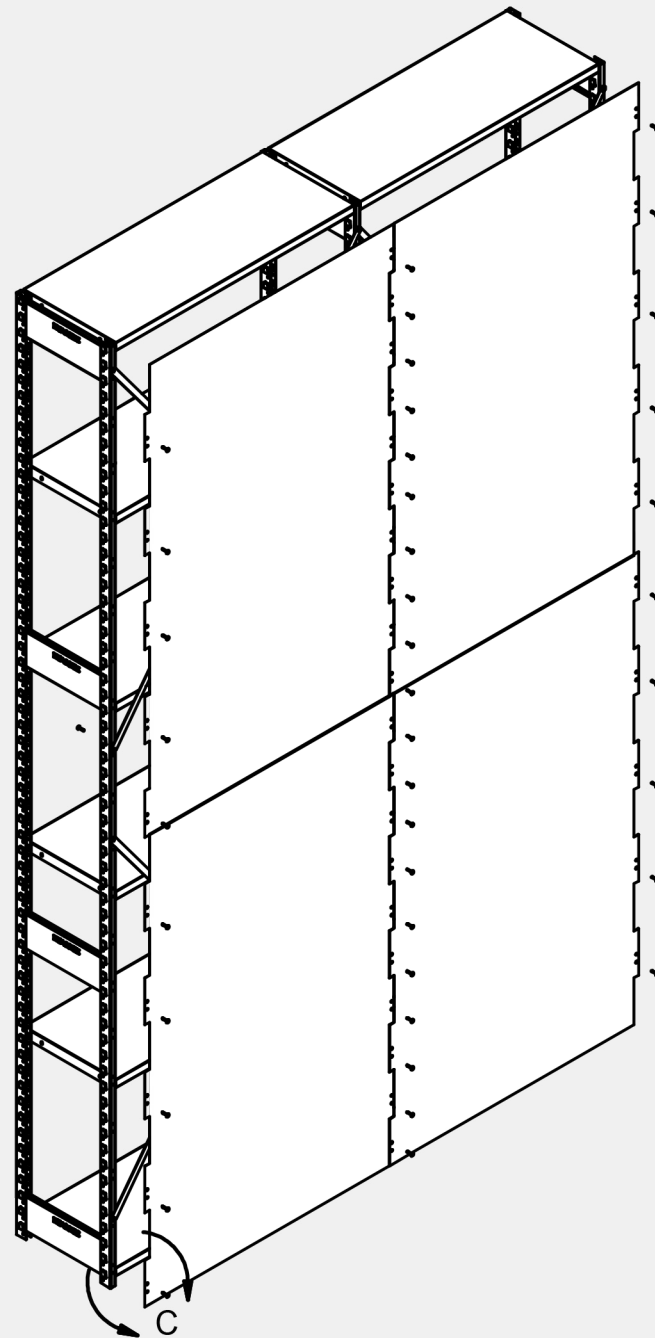

INSTALL BOTH UNITS TOGETHER BACK TO BACK WITH SELF TAPPING SCREW.

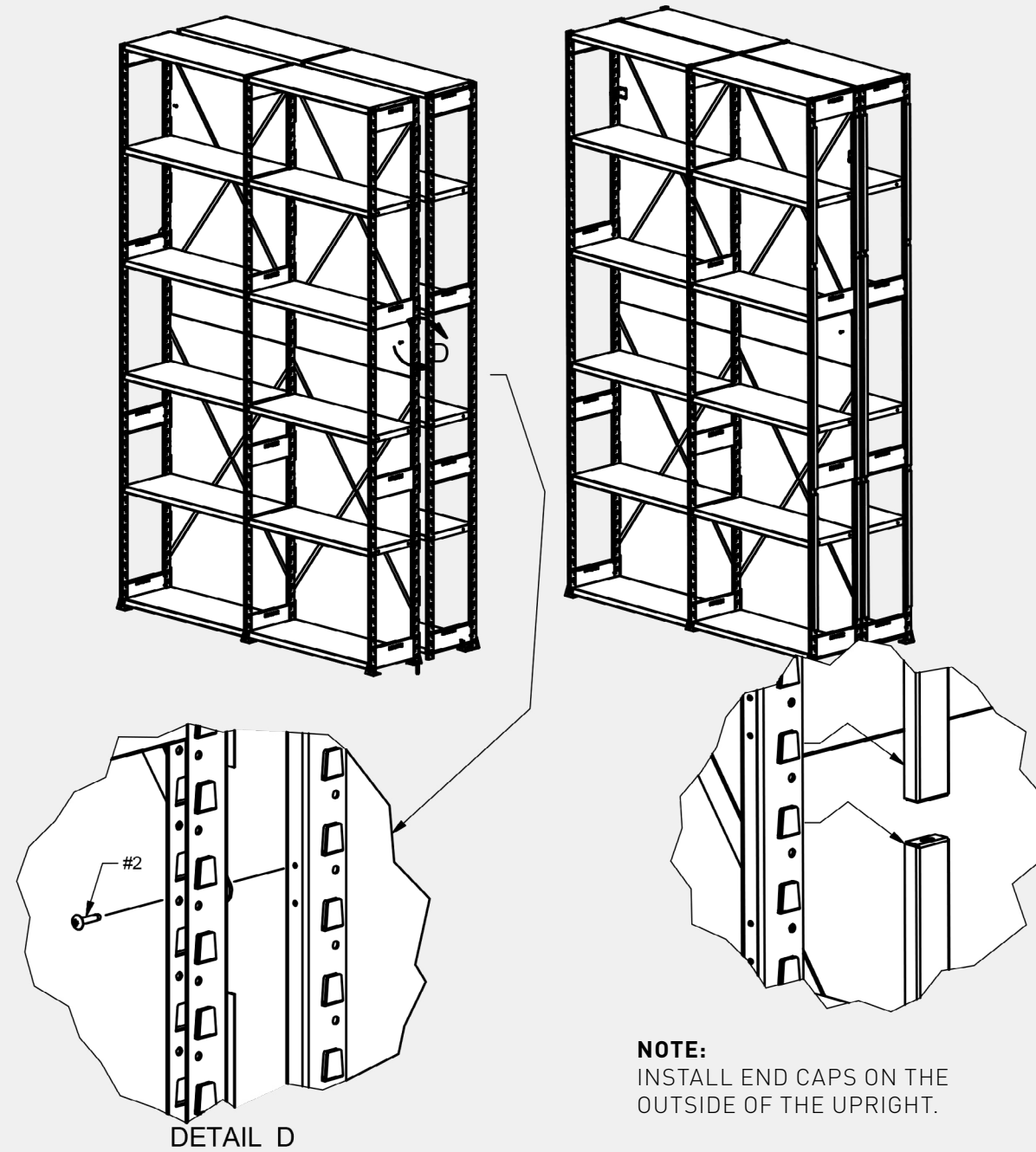

NOTE:
INSTALL END CAPS ON THE
OUTSIDE OF THE UPRIGHT.

UPRIGHT	FIX	MOBILE
72" H	PER POST 2 X 30" H.	PER POST 2 X 30" H.
96" H	PER POST 3 X 30" H.	PER POST 1 X 30" H. / 1 X 48" H
120" H	PER POST 2 X 30" H. / 1 X 48" H	PER POST 2 X 30" H. / 1 X 48" H
144" H	PER POST 1 X 30" H. / 2 X 48" H	PER POST 1 X 30" H. / 2 X 48" H

ETALEX

MOBILE UNIT ASSEMBLY

2 PERSONS NEEDED TO LIFT THE RACKING AND DEPOSIT ON THE TROLLEY.

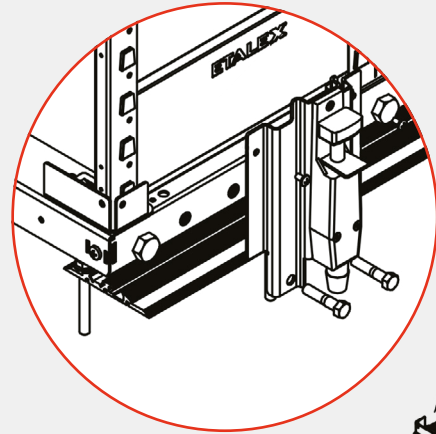
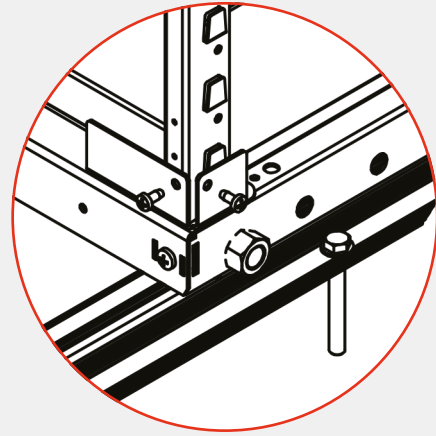

NOTE:
INSTALL THE BRAKE
IN THE END

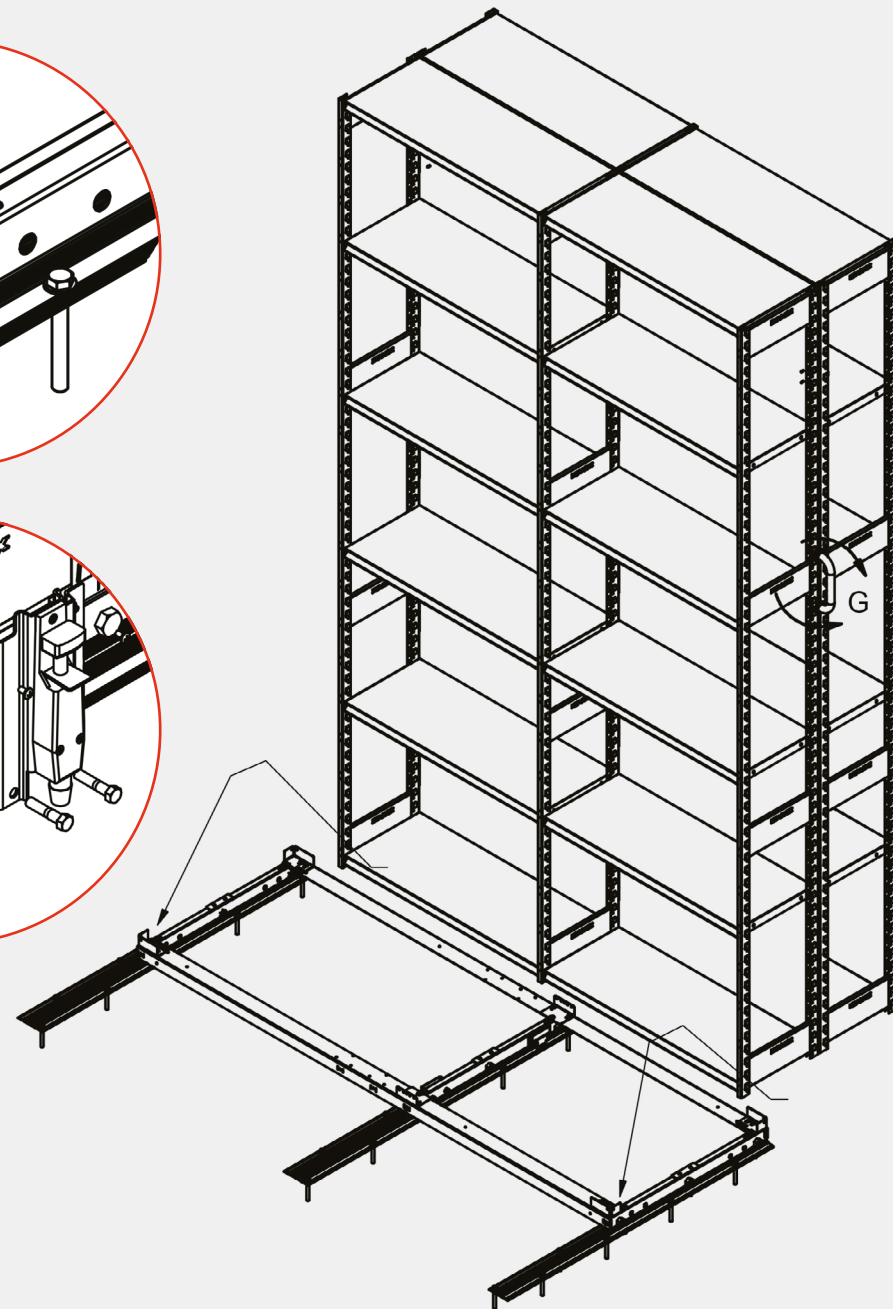

SET IN PLACE THE
HANDLE BY SLIDING
IN THE ASSEMBLY PART
AND SECURE THEM
WITH THE TEK SCREWS
NO 10 X 3/4" L.

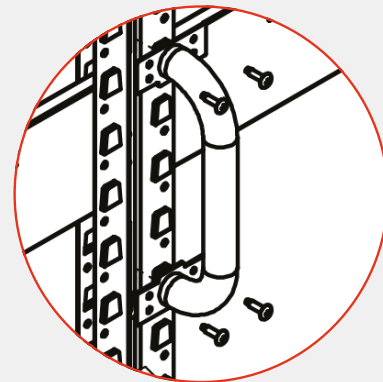

DETAIL G

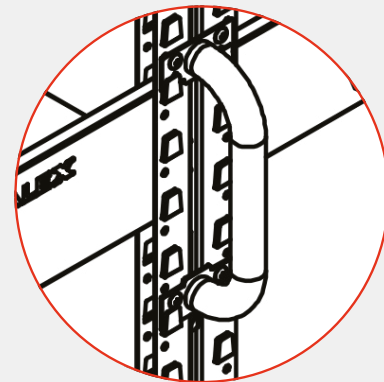

ASSEMBLY VIEW

HD UNIT ASSEMBLY

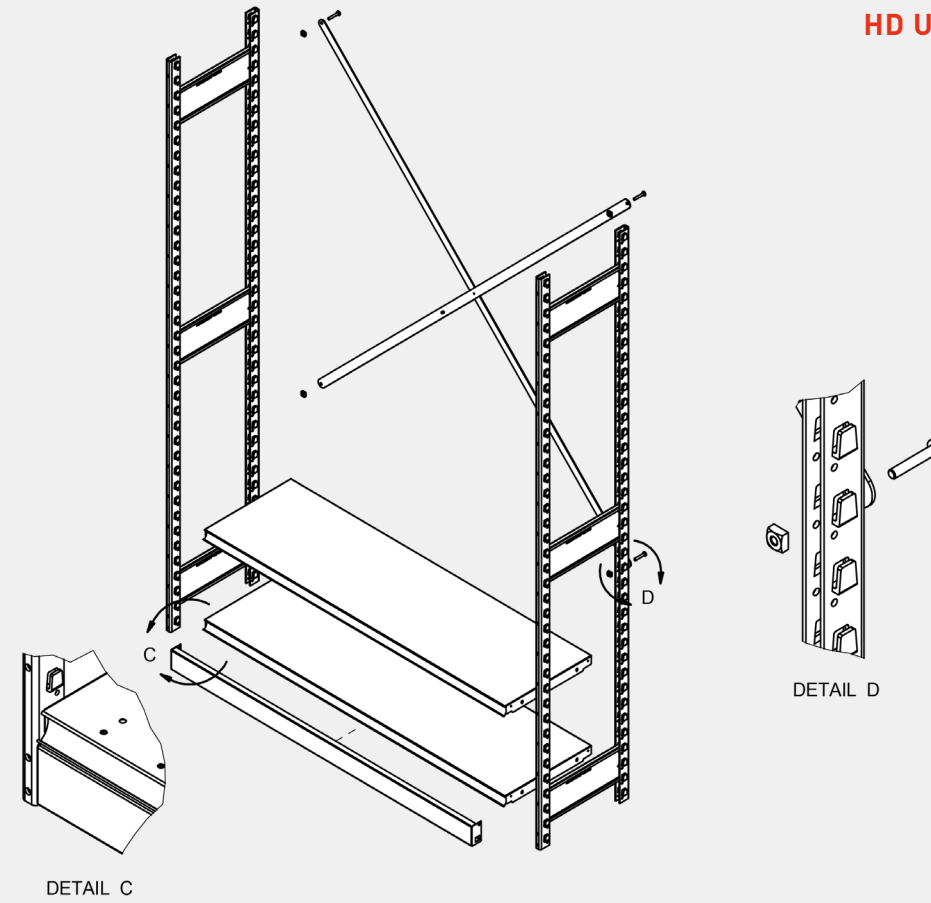

DETAIL C

DETAIL D

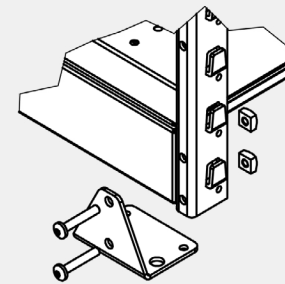

DETAIL E

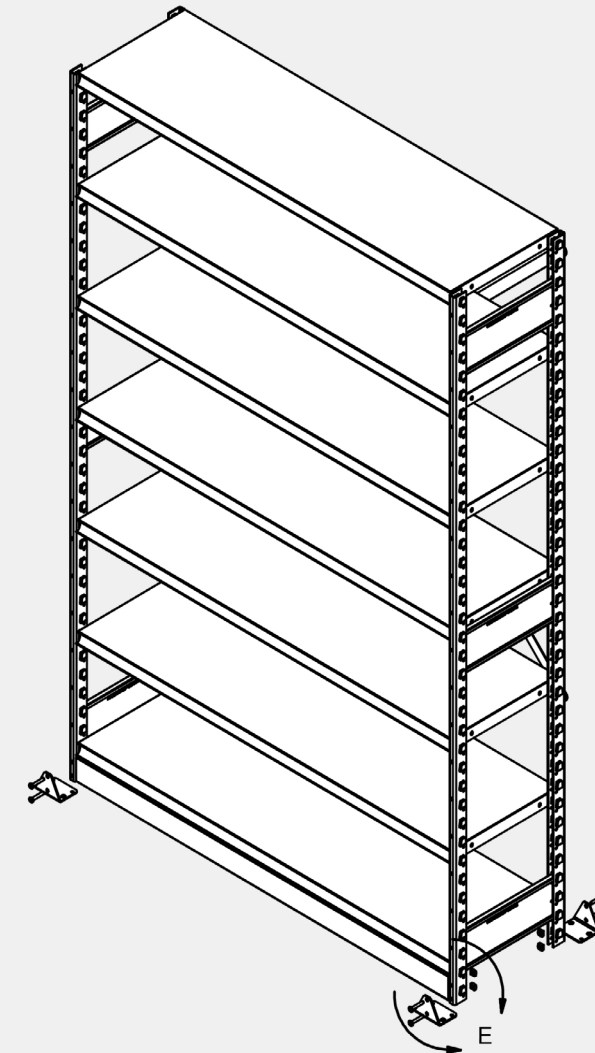

ETALEX



CONTACT US

ANJOU PLANT

8501, rue Jarry Est,
Anjou, QC H1J 1H7

T 514 351-2000

Free 1 800 351-3125

SAINT-BRUNO PLANT

1299, Marie-Victorin,
St-Bruno, QC J3V 6B7

T 450 653-1299

Free 1 888 224-BONI

MTL-NORD PLANT

5151, Boulevard Industriel,
Montréal, QC H1G 3H2

T 514 325-9892

Free 1 877 525-9892



FACEBOOK/SJM



LINKEDIN/SJM

MADE IN CANADA

