



## COLD ROOM SHELVING

INSTALLATION GUIDE,  
COMPONENTS,  
ACCESSORIES AND CODES.



## **GALVANIZED WALL**

Our adjustable and user-friendly galvanized steel wall posts have been specially designed for cold rooms and freezers with limited space. The design allows for installation away from the wall to avoid pipes and other obstructions on the wall. Stainless steel channels are also available.

## **SPECIFICATIONS**

**Post height : 72" - 126"**

**Post extension height : 9" - 48"**

**Shelf length : 24", 30", 36", 42", 46"**

**Shelf depth : 12", 18", 24"**



PARTS LIST GALVANIZED WALL		
ITEM	QTY	DESCRIPTION
1	2	GALVANIZED POST
2	2	EXTENSION
3	6	GALVANIZED WALL MOUNT FASTENER
4	4	RIGHT BRACKET 18"
5	4	LEFT BRACKET 18"
6	12	SLAT
7	28	HEX SELF TAPPING SCREW NO 14 X 1 1/2" L



ITEM #1  
GALVANIZED  
POST  
X2



ITEM #2  
POST  
EXTENSION  
X2

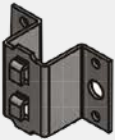

ITEM #3  
GALVANIZED WALL  
MOUNT FASTENER  
X6

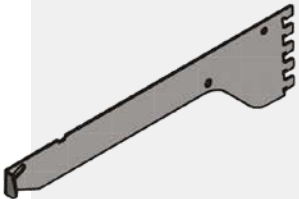

ITEM #4  
LEFT  
BRACKET  
X4

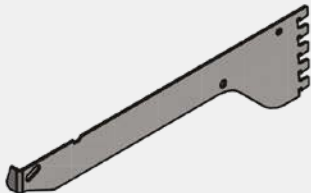

ITEM #5  
RIGHT  
BRACKET  
X4

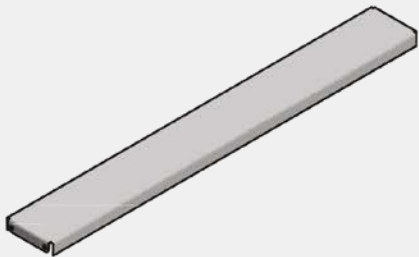

ITEM #6  
GALVANIZED  
SLAT  
X12

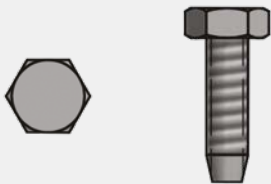

ITEM #7  
HEX SELF TAPPING SCREW  
#14 X 1 1/2" L  
X28

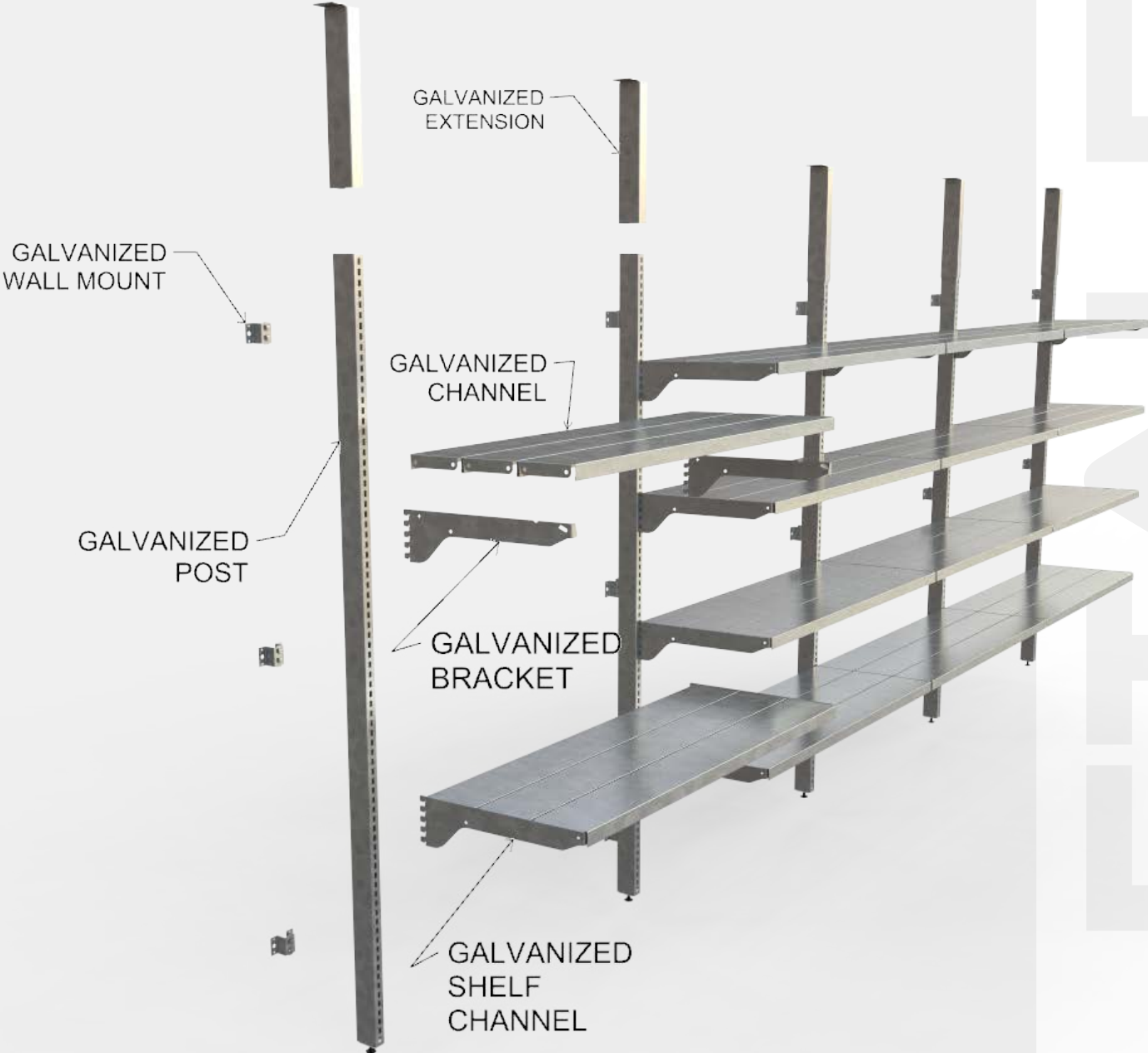

## ASSEMBLY

### STEP 1:

TO GUIDE THE LOCATION OF THE GALVANIZED POST AND THE WALL MOUNT FASTENERS, USE A MEASURING TAPE AND MARK THE LOCATIONS VERTICALLY.

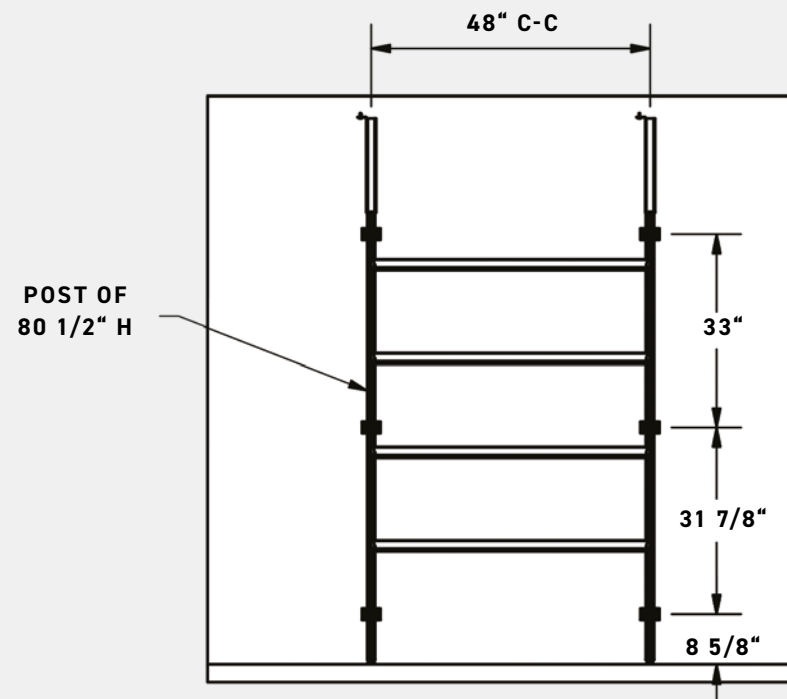

### STEP 2:

ADJUST THE LEVELER TO 1/2" - 3/4" AND SET THE UPRIGHT VERTICALY AGAINST THE WALL. **FIG.1**

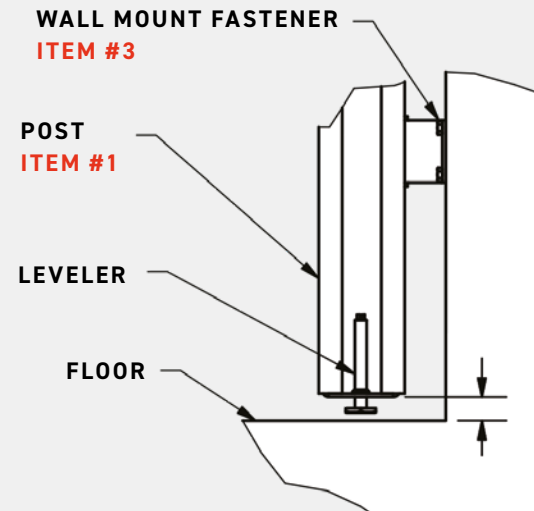

### STEP 3:

PLACE 3 WALL MOUNT FASTENERS WITH THE TEETH FACING UP (ITEM#3) IN EACH POST ON YOUR VERTICAL MARKS (AT THE BOTTOM, MIDDLE AND THE TOP) AND SECURE TO THE REAR WALL WITH THE HEX FLANGE SELF TAPPING SCREW #14 X 1" (ITEM#7).

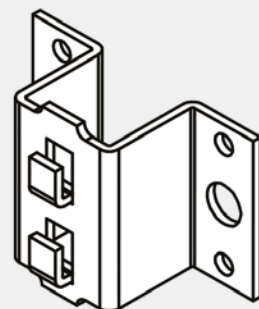

## ASSEMBLY

### STEP 4:

INSERT THE POST EXTENSION (ITEM#2) ON THE TOP OF THE GALVANIZED POST. INSERT AND SLIDE DOWN THE POSTS IN THE WALL MOUNT FASTENERS. SCREW THE EXTENSION AGAINST THE CEILING WITH THE HEX SELF TAPPING SCREW #14 X 1 1/2" L (ITEM#7) FOR FINALLY ADJUST THE LEVELERS ON THE FLOOR..

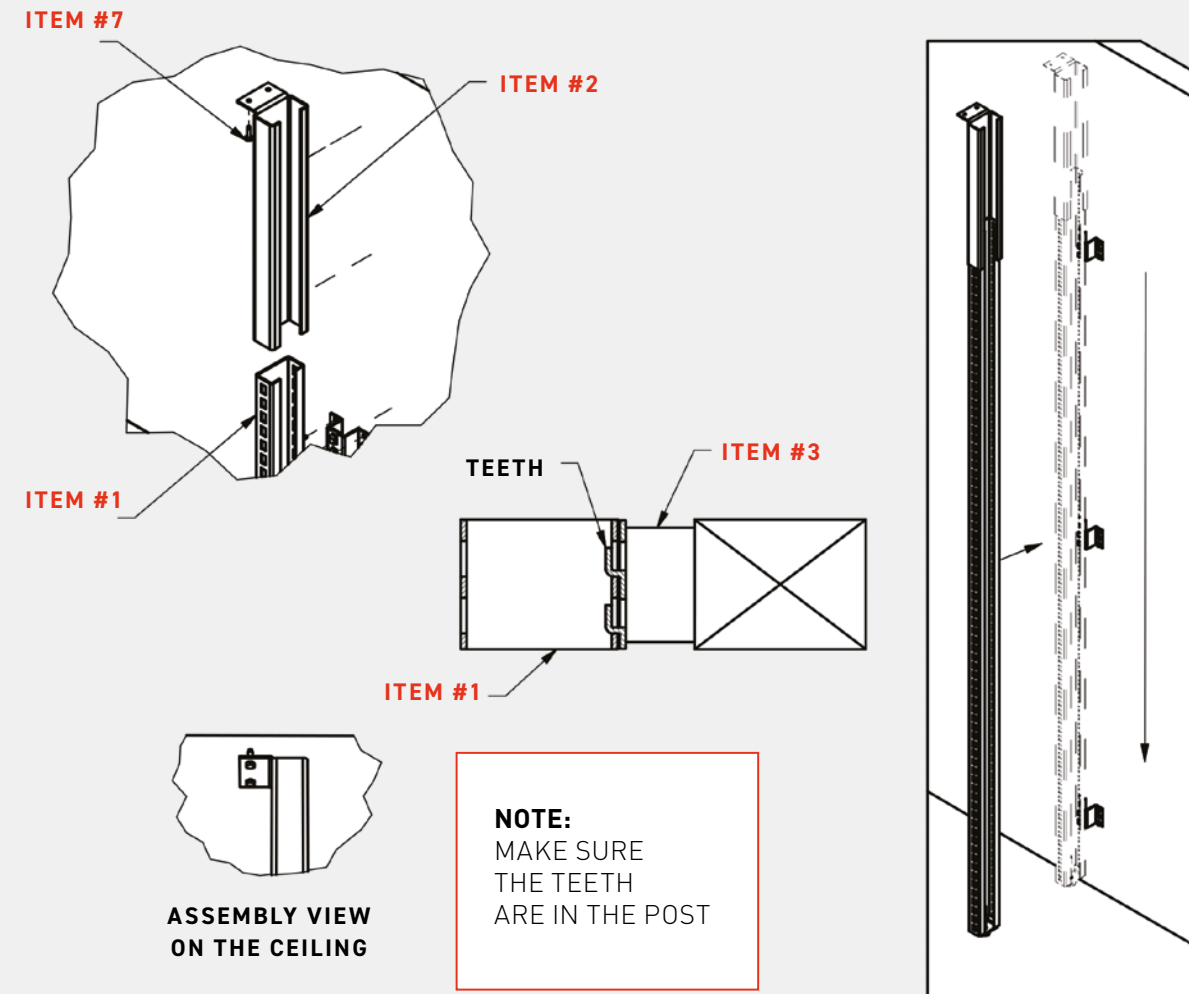

### STEP 5:

INSTALL THE SHELF BRACKETS (ITEM#4-5) AND THE GALVANIZED SLATS (ITEM#6) AT THE DESIRED HEIGHT.

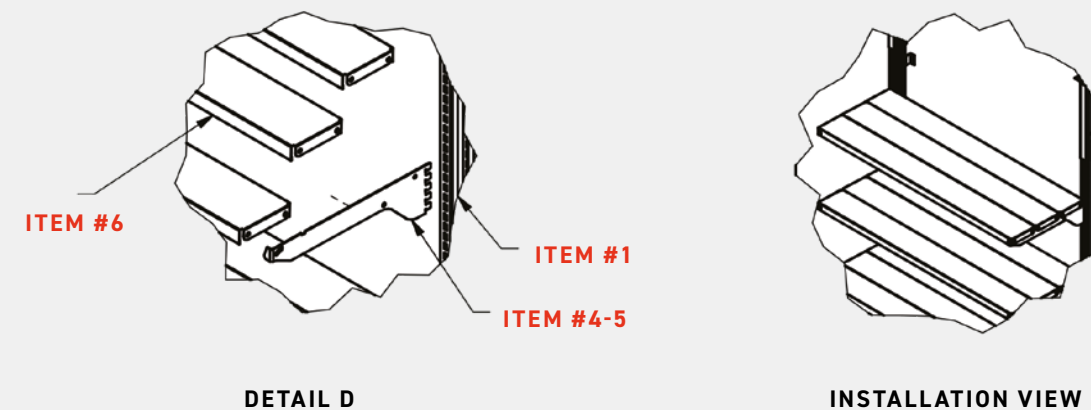



## STAINLESS STEEL WALL

Our stainless steel wall posts are ideal for storing food. This system complies with MAPAC standards for shelving in highly corrosive environments.

## SPECIFICATIONS

Post height : 84" - 120"

Extensions height : 9" - 40"

Platform length : 24", 30", 36", 42", 46"

Shelf depth : 18", 24"

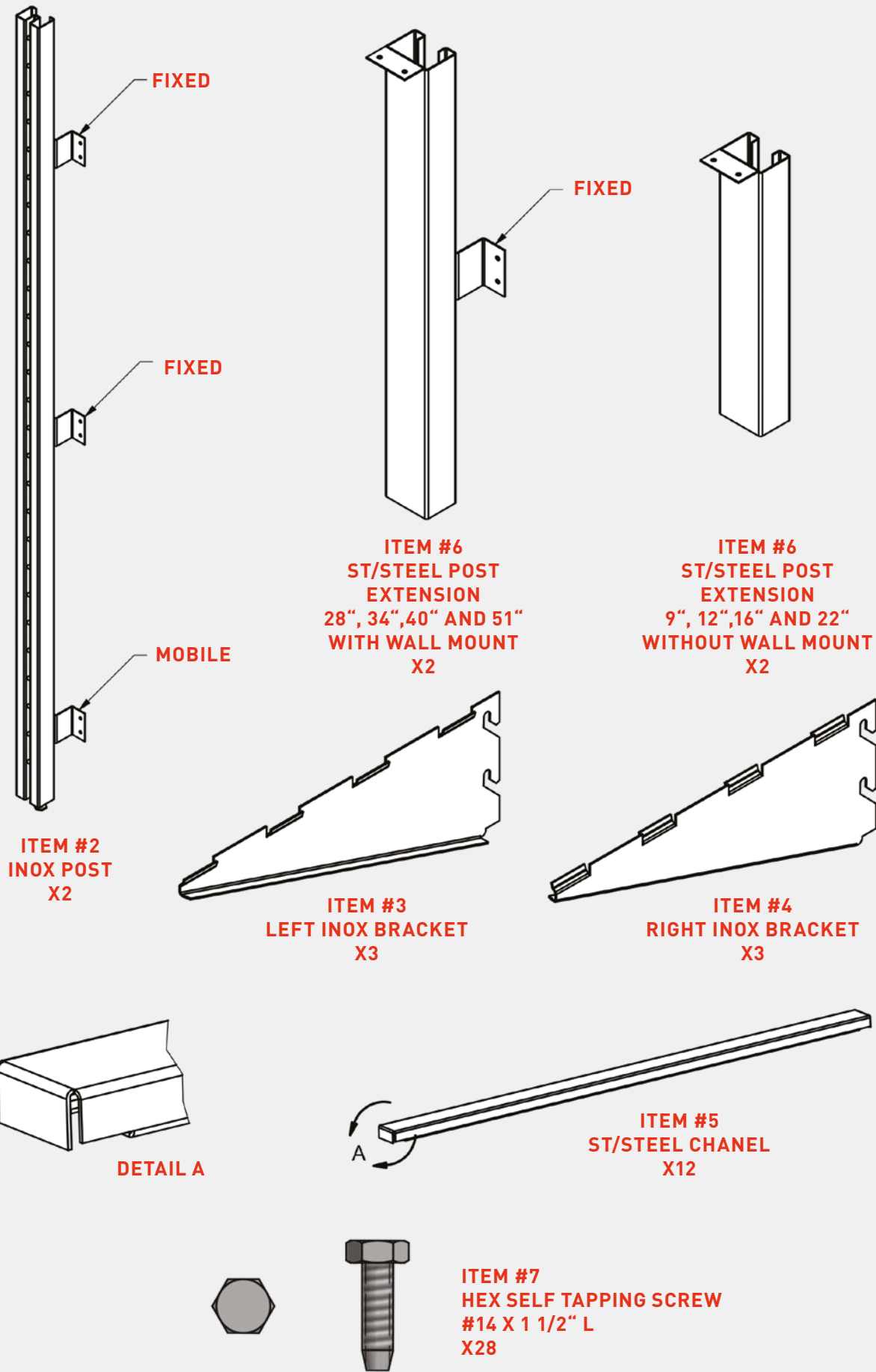

PARTS LIST STAINLESS STEEL WALL		
ITEM	QTY	DESCRIPTION
1	40	HEX SELF TAPPING SCREW SS NO 14 x 1 1/2"
2	2	INOX POST 84" + 3 WALL MOUNT 2 1/2"
3	3	LEFT INOX BRACKET 18"
4	3	RIGHT INOX BRACKET 18"
5	12	ST/STEEL CHANEL-14ga 2 1/4"
6	2	ST/STEEL POST EXTENSION
SYSTEM LOAD CAPACITY		
LOAD CAPACITY PER SECTION : 600 LB / LOAD CAPACITY PER SHELF : 300 LB		



**NOTE:**  
THE INDICATED CAPACITIES ARE FOR THE SHELVES AND SUPPORT ONLY. IT IS THE OWNER'S RESPONSIBILITY TO ENSURE THAT THE STRUCTURE ON WHICH THE SHELVING IS INSTALLED IS STRONG ENOUGH TO HOLD THOSE SPECIFICATIONS.



**STEP 1:**

MARK THE LOCATION OF THE ST/STEEL POSTS AND THE WALL MOUNT FASTENERS, ON A VERTICAL LINE.

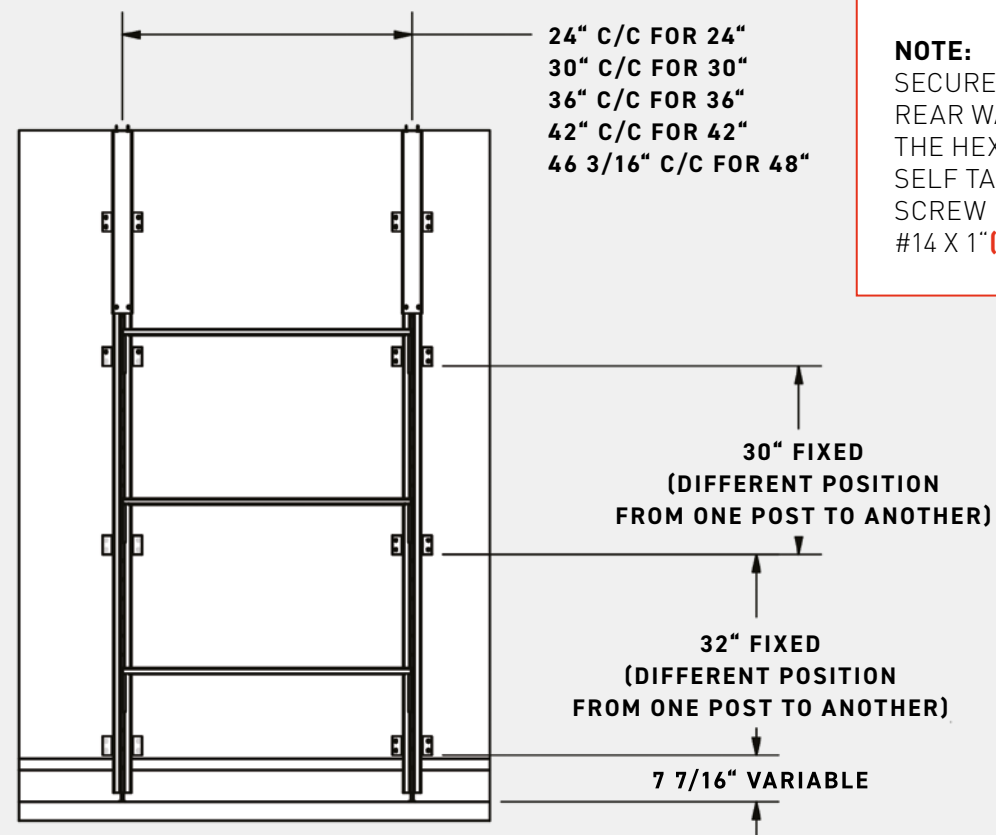

**NOTE:**  
SECURE TO THE  
REAR WALL WITH  
THE HEX FLANGE  
SELF TAPPING  
SCREW  
#14 X 1" (ITEM#1).

**STEP 2:**

ADJUST THE LEVELER TO 3/4" AND SET THE UPRIGHT VERTICALTY AGAINST THE WALL.

**FIG.1**

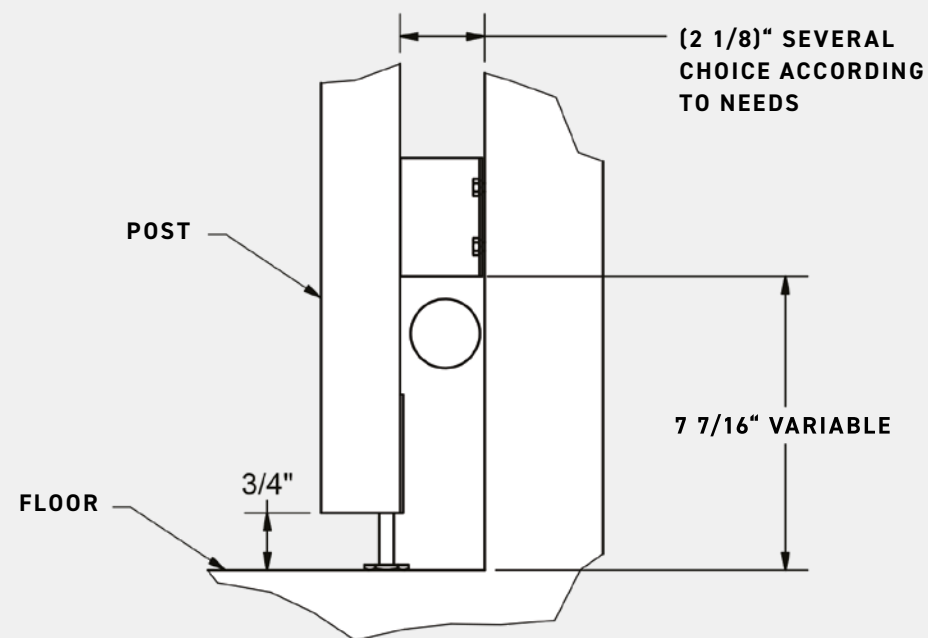

**FIG.1**

**STEP 3:**

INSERT THE POST EXTENSION (ITEM#6) ON THE TOP OF THE INOX POST. INSERT AND SLIDE DOWN THE POSTS IN THE WALLS MOUNTS FASTENERS. SCREW THE EXTENSION AGAINST THE CEILING WITH THE HEX SELF TAPPING SCREW #14 X 1 1/2" L (ITEM#1). LASTLY, ADJUST THE LEVELERS ON THE FLOOR.

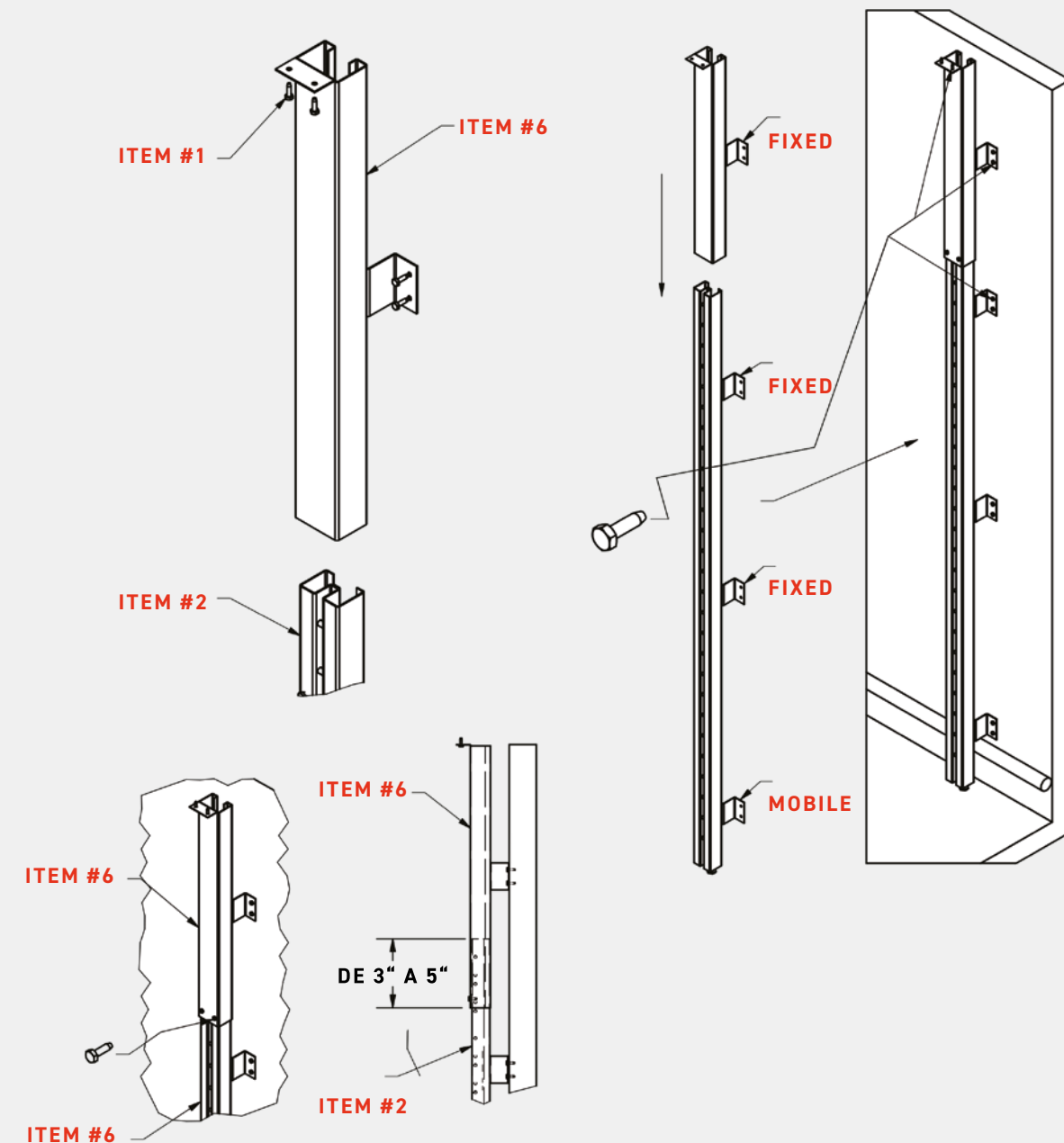

**NOTE:**

MINIMUM 6" OF OVERLAP BETWEEN THE POST AND THE EXTENSIONS.  
\*\*\*EXCEPTIONALLY BETWEEN 3" AND 5", FIX THE EXTENSION TO THE POST  
WITH 2 SELF-TAPPING SCREW #14X 1" L.\*\*\*  
BELOW 3" OF OVERLAPPING, USE A LONGER EXTENSION.

**STEP 4:**  
INSTALL THE BRACKETS (ITEM#3-4) AND THE INOX SLATS (ITEM#6) AT THE DESIRED  
HEIGHT.

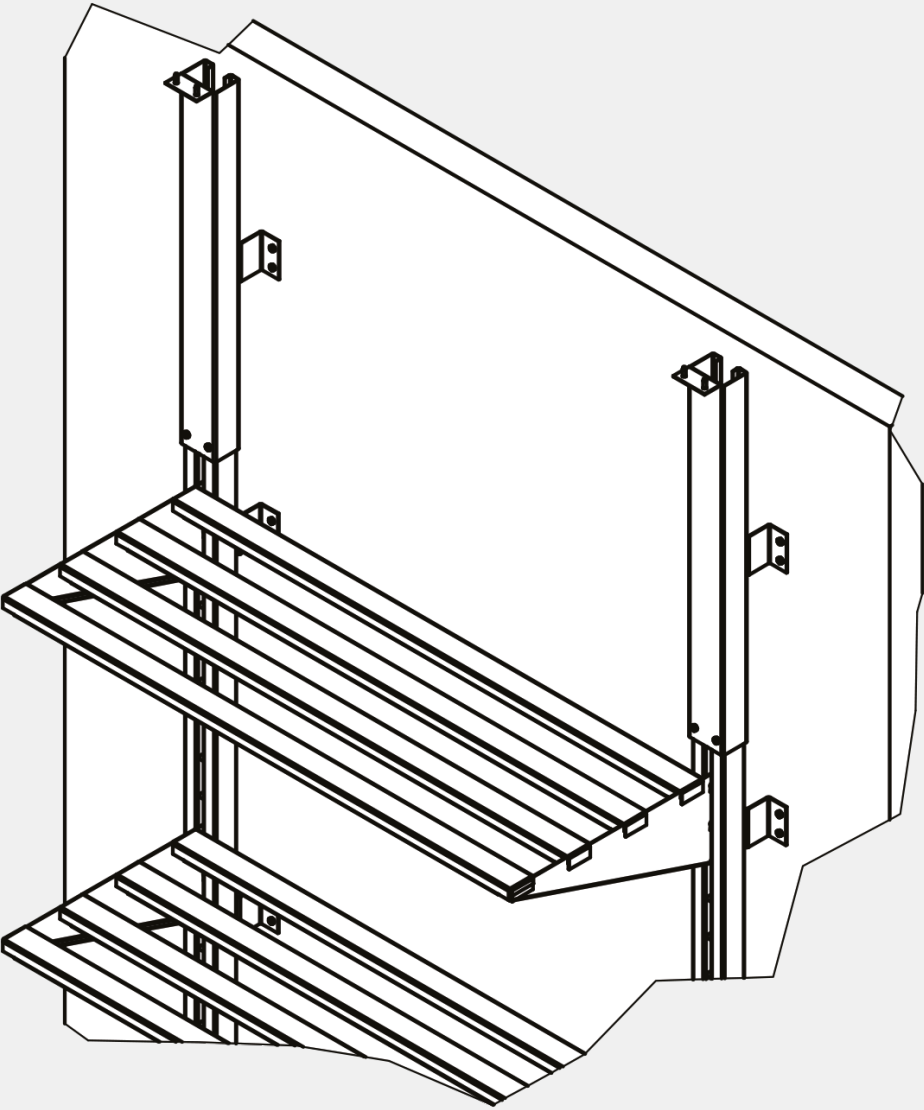
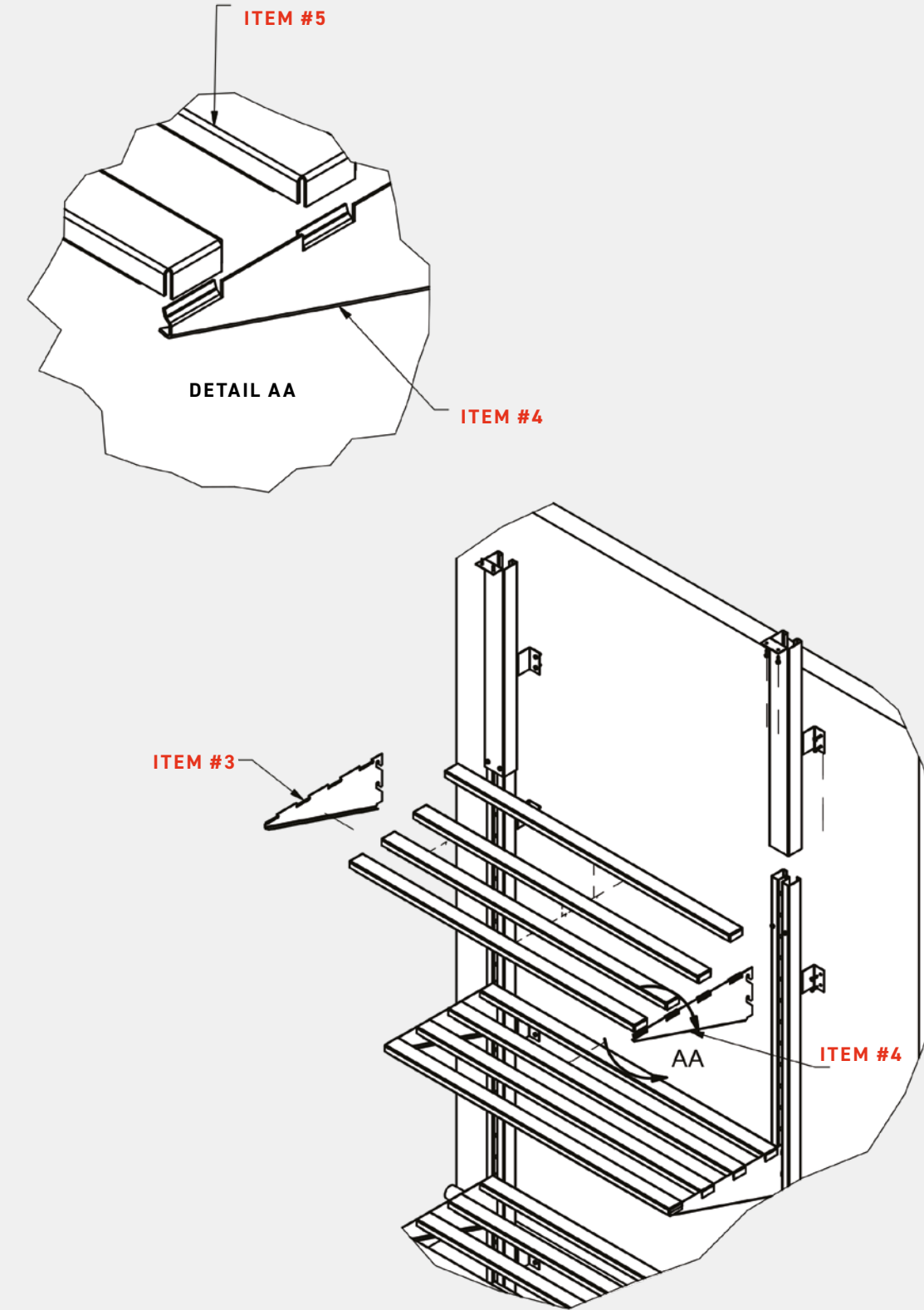

INSTALLATION VIEW  
COMPLETED





## BACKLESS WALL

Our backless wall unit is the recommended solution for beer caves in grocery and convenience stores. Quick installation, durability and versatility are the hallmarks of its success.

## SPECIFICATIONS

Post height : 72" - 126"

Extensions height : 9" - 48"

Shelf length : 24", 30", 36", 42", 46"

Shelf depth : 12", 18", 24"

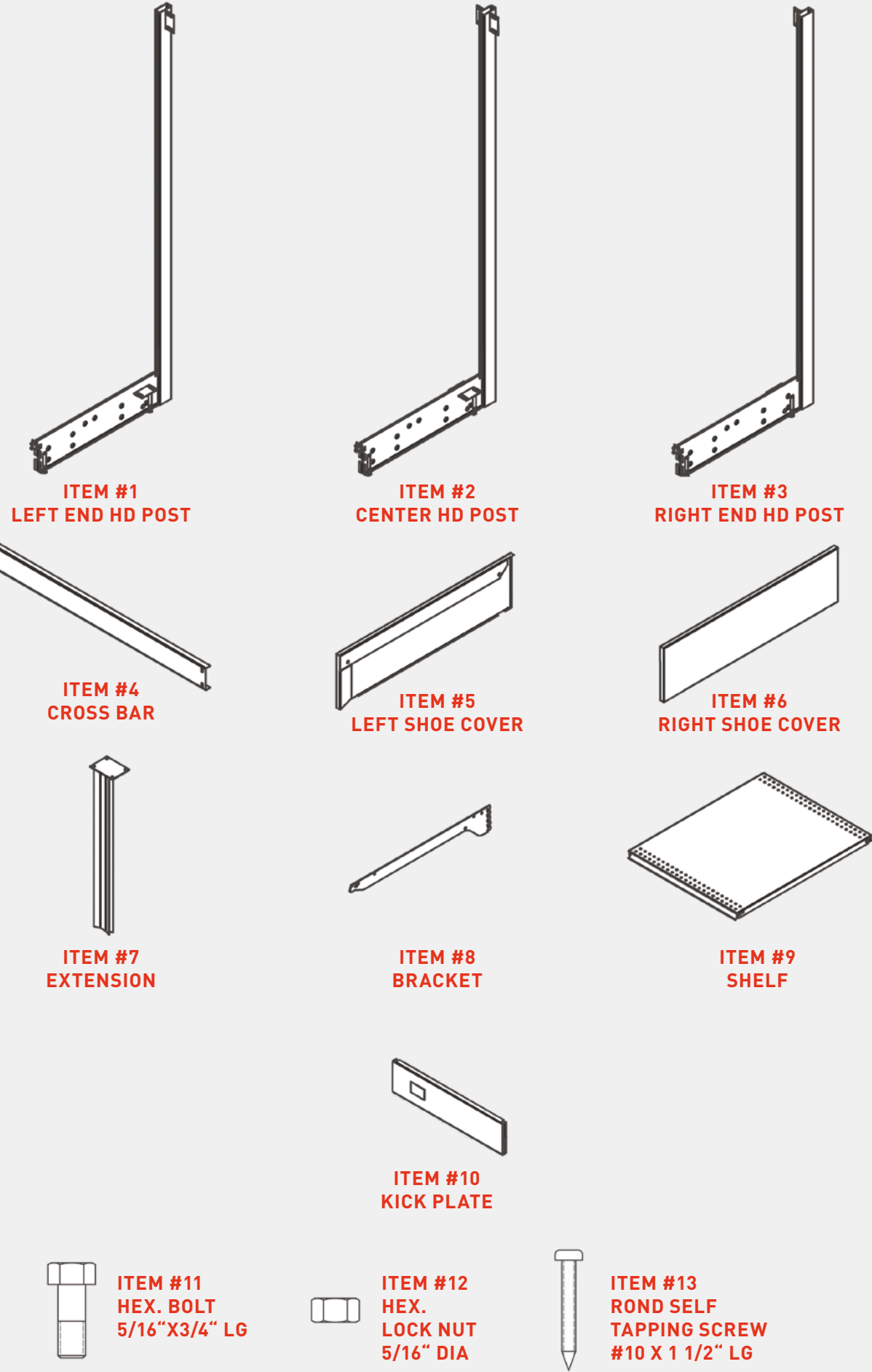

PARTS LIST BACKLESS WALL		
ITEM	QTY	DESCRIPTION
1	1	LEFT END HD POST 95 1/4" P30" + 1 ATT 1 PLA
2	4	CENTER HD POST 95 1/4" P30 + 2 ATT + 2 PLA
3	1	RIGHT END HD POST 95 1/4" P30" + 1 ATT + 1 PLA
4	10	CROSS BAR 4"H X 28 3/4"
5	1	LEFT SHOE COVER 30"
6	1	RIGHT SHOE COVER 30"
7	6	EXTENSION 36" BOUT
8	20	BRACKET 30" (.121)
9	15	SHELF 30" X 30"
10	5	REG. KICK PLATE 30"
11	40	BOLT HEX. 5/16" X 3/4"L GR 2
12	40	LOCK NUT HEX 5/16" DIA GR 2
13	24	SLOTTED PAN HEAD SELF TAPPING SCREW #10 X 1 1/2" L

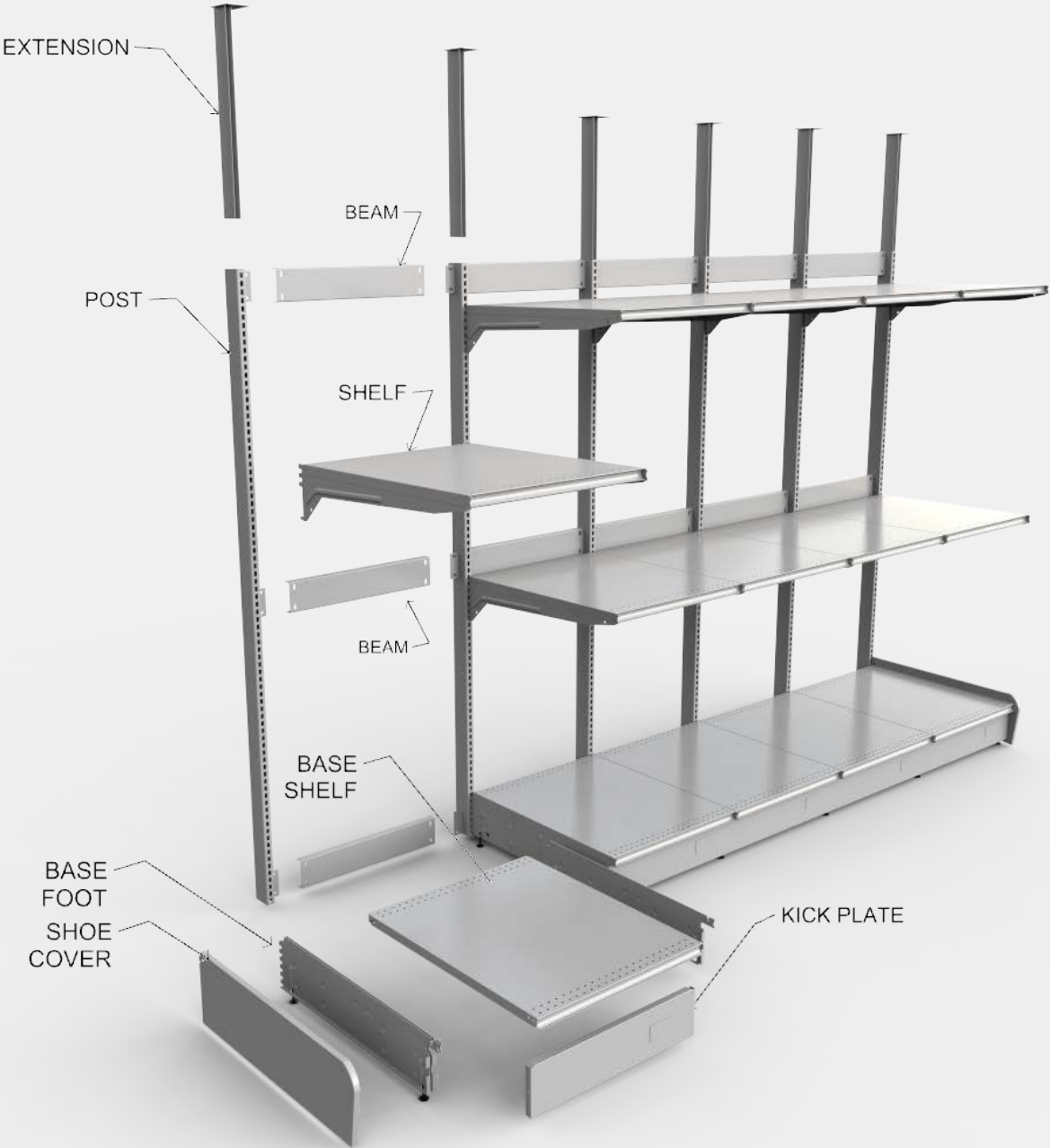

## ASSEMBLY

### STEP 1:

LAY DOWN AND PLACE THE POSTS (ITEM#1, 2, 3), EXTENSION (ITEM#7) AND THE CROSS BARS (ITEM#4).



**IMPORTANT**  
THE SPACE BETWEEN  
THE DOOR AND MURAL  
MUST BE 6".

#### NOTE:

START WITH THE LEFT POST, THEN  
CENTER POST AND FINISH WITH  
THE RIGHT POST.

FIG.1

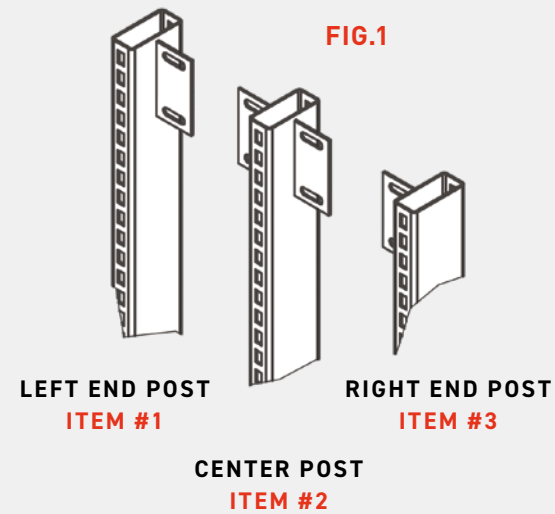

### STEP 2:

UNSCREW THE LEVELERS  
APPROXIMATELY 3/4" IN FRONT  
AND 1/2" IN BACK.

FIG.2

#### NOTE:

DO NOT UNSCREW THE LEVELERS  
MORE THAN 1 1/2".

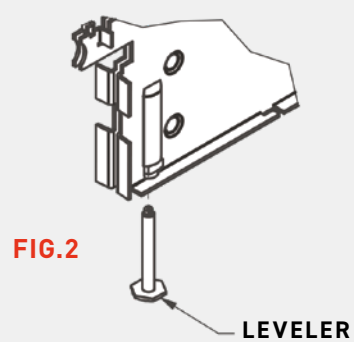

### STEP 3:

INSERT THE EXTENSIONS (ITEM#7)  
INTO THE POSTS (ITEM#1,2,3).

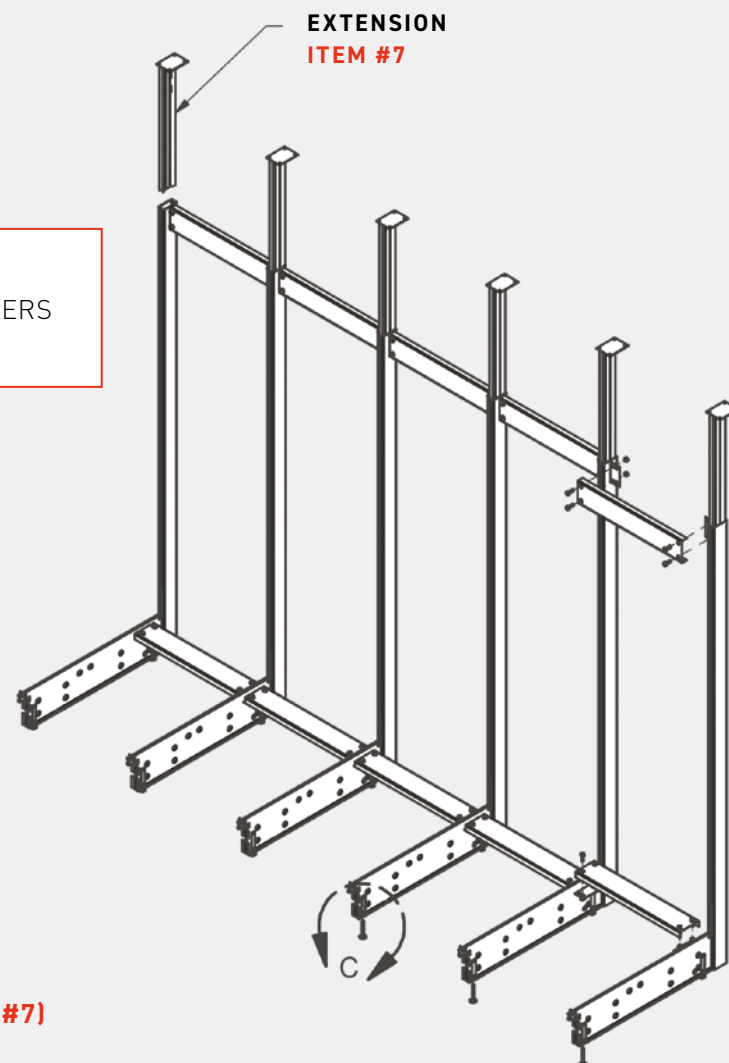

## ASSEMBLY

### STEP 4:

WITH THE LEFT POST AND ONE CENTER POST IN THE VERTICAL POSITION, JOIN THEM  
WITH THE BOTTOM AND TOP CROSS BAR (ITEM#4) AND SECURE THEM WITH THE BOLTS  
5/16" X 3/4" LG (ITEM#11) AND LOCK NUTS (ITEM#12). DO NOT TIGHTEN. FIG.3

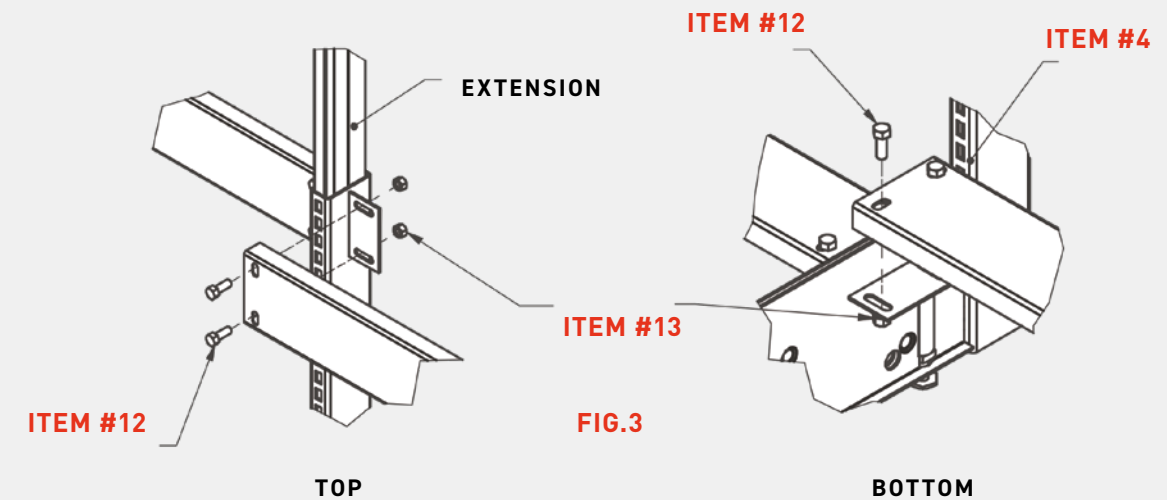

### STEP 5:

INSTALL THE BASE SHELF (ITEM#9) AND THE KICK PLATE (ITEM#10) TO STABILIZE THE  
STRUCTURE AND HELP IN THE LEVELING. INSTALL THE REMAINING STRUCTURES THE  
SAME WAY. INSTALL THE POST EXTENSIONS.

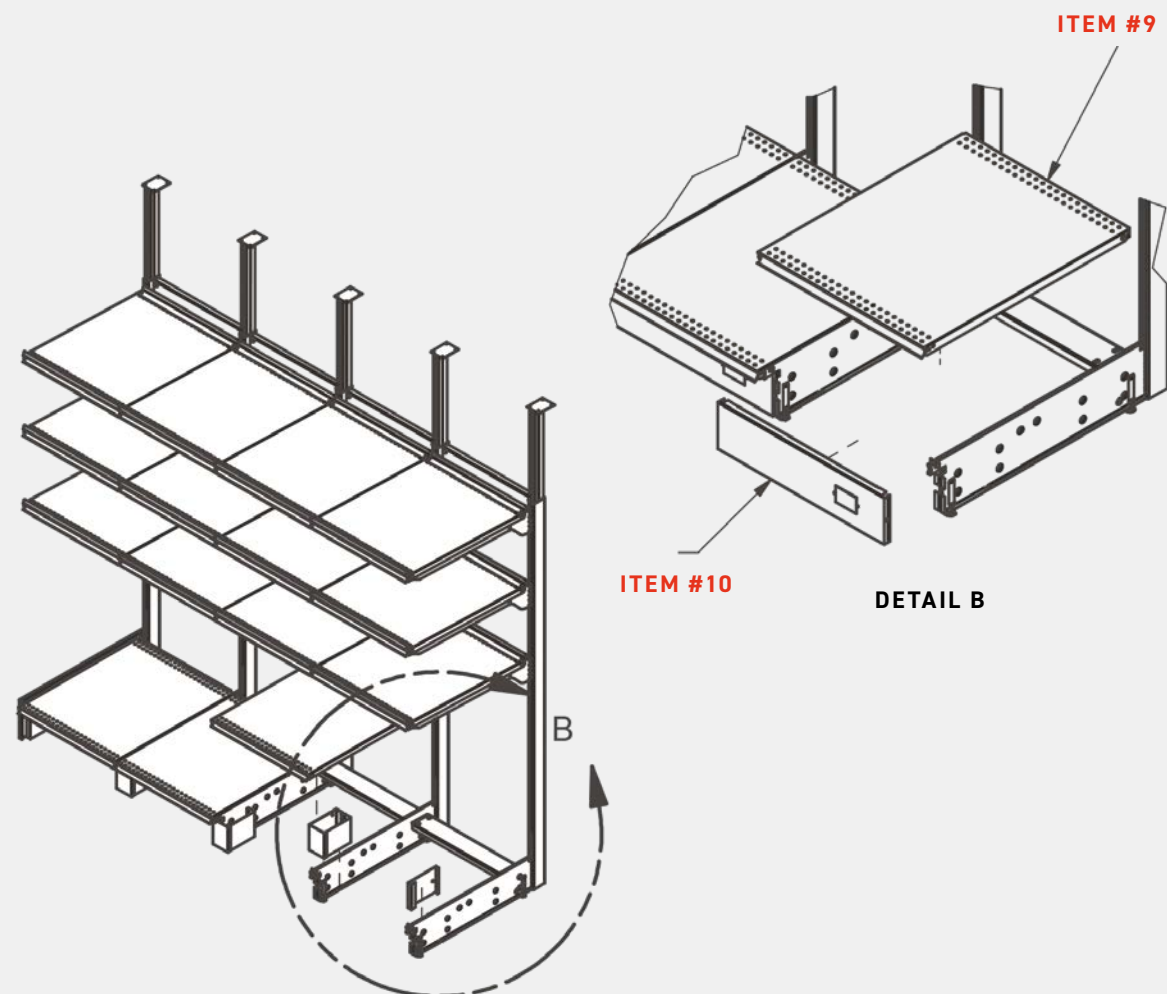



ASSEMBLY

**STEP 6:**  
POSITION THE WALL UNIT IN THE FINAL LOCATION, LEVEL AND PLUMB THE UNIT THEN  
TIGHTEN ALL THE CROSS BARS (ITEM#4). ONCE LEVELED, SCREW THE EXTENSIONS TO  
THE CEILING WITH THE SELF TAPPING SCREW #10 X 1 1/2" (ITEM#14).  
**FIG.4**

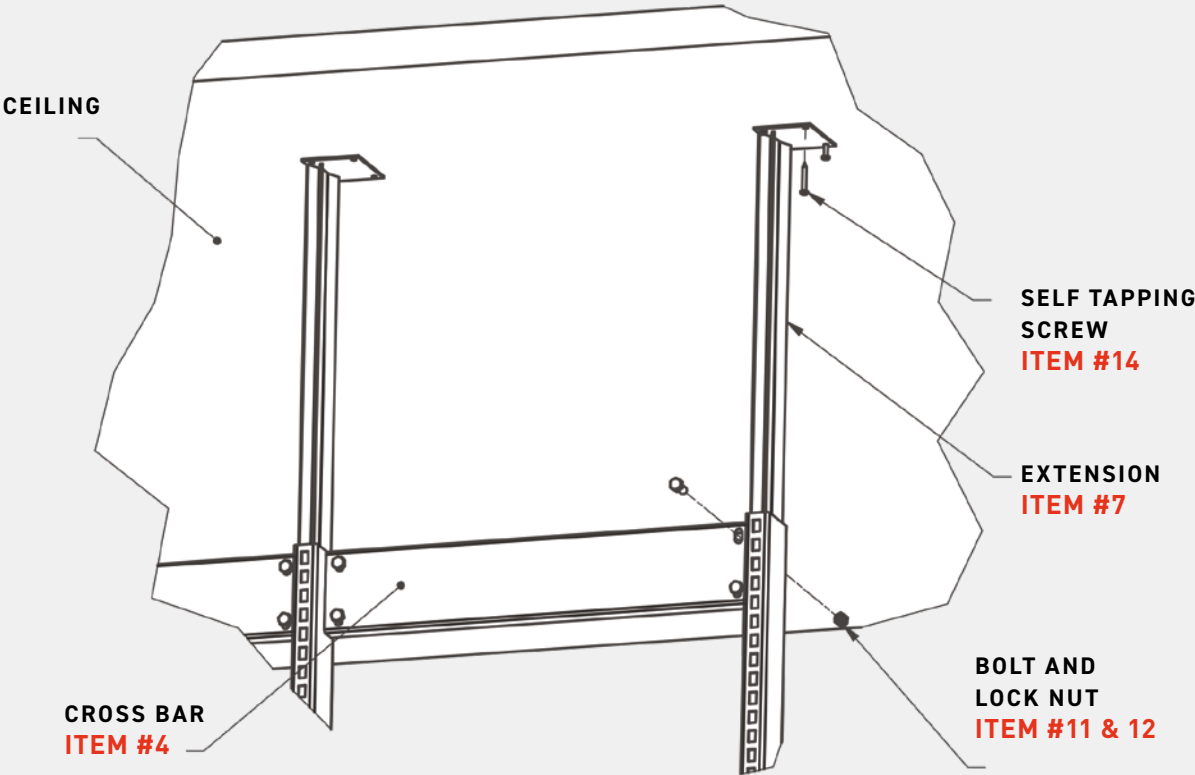

**STEP 7:**  
INSTALL THE BRACKETS (ITEM#18), UPPER SHELVES (ITEM#9) AND THE SHOE COVERS (ITEM#5, 6) ON BOTH ENDS.

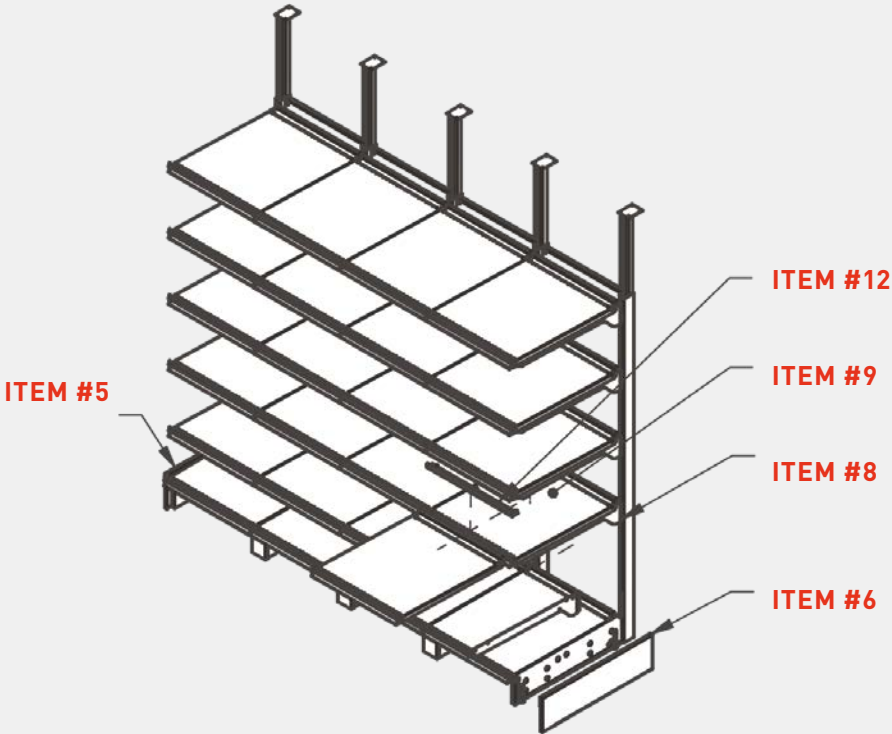

ASSEMBLY

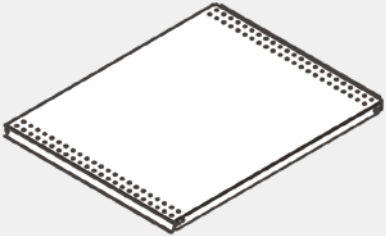

SHELF WITH  
RIVETED  
MOULDING

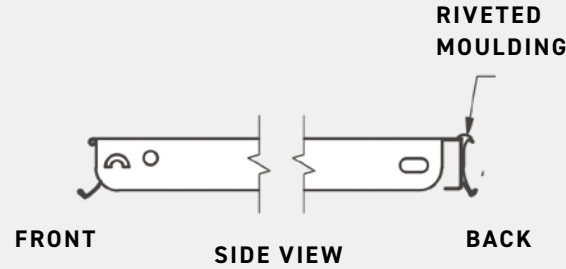

**NOTE:** WHEN INSTALLING THE SHELVES, MAKE SURE THE RIVETED MOLDING (ITEM#8) FACES BACKWARDS.

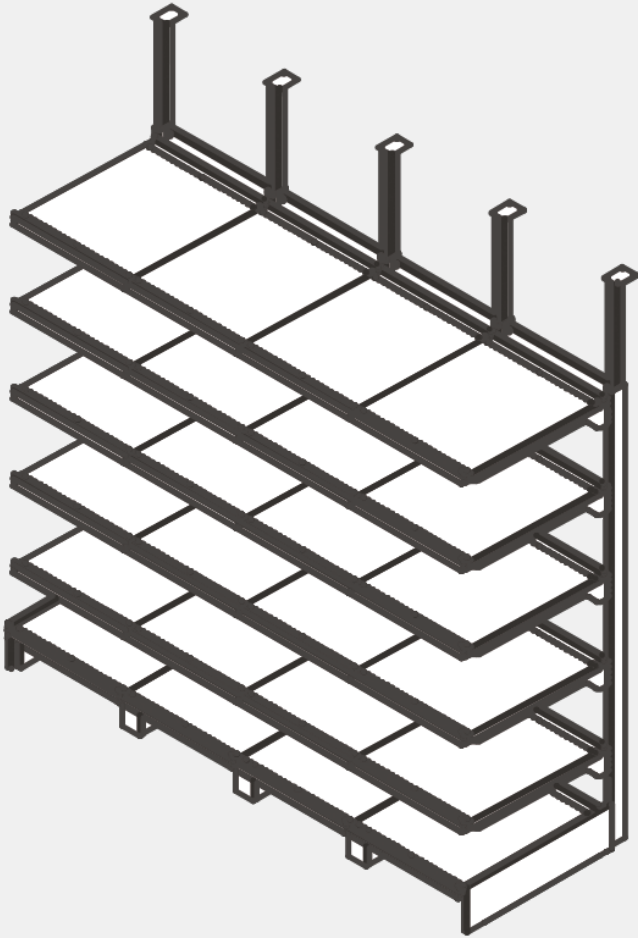



## OMEGA WALL

With fast and simple installation, our Omega wall is the go-to solution for cold rooms that are difficult to access. A stainless steel slats option is also available.

### SPECIFICATIONS

**Post height :**  
84"- 96"  
**Post extension height :**  
12"- 30"

**Shelf length :**  
24"- 48"  
**Shelf depth :**  
12", 18", 24"

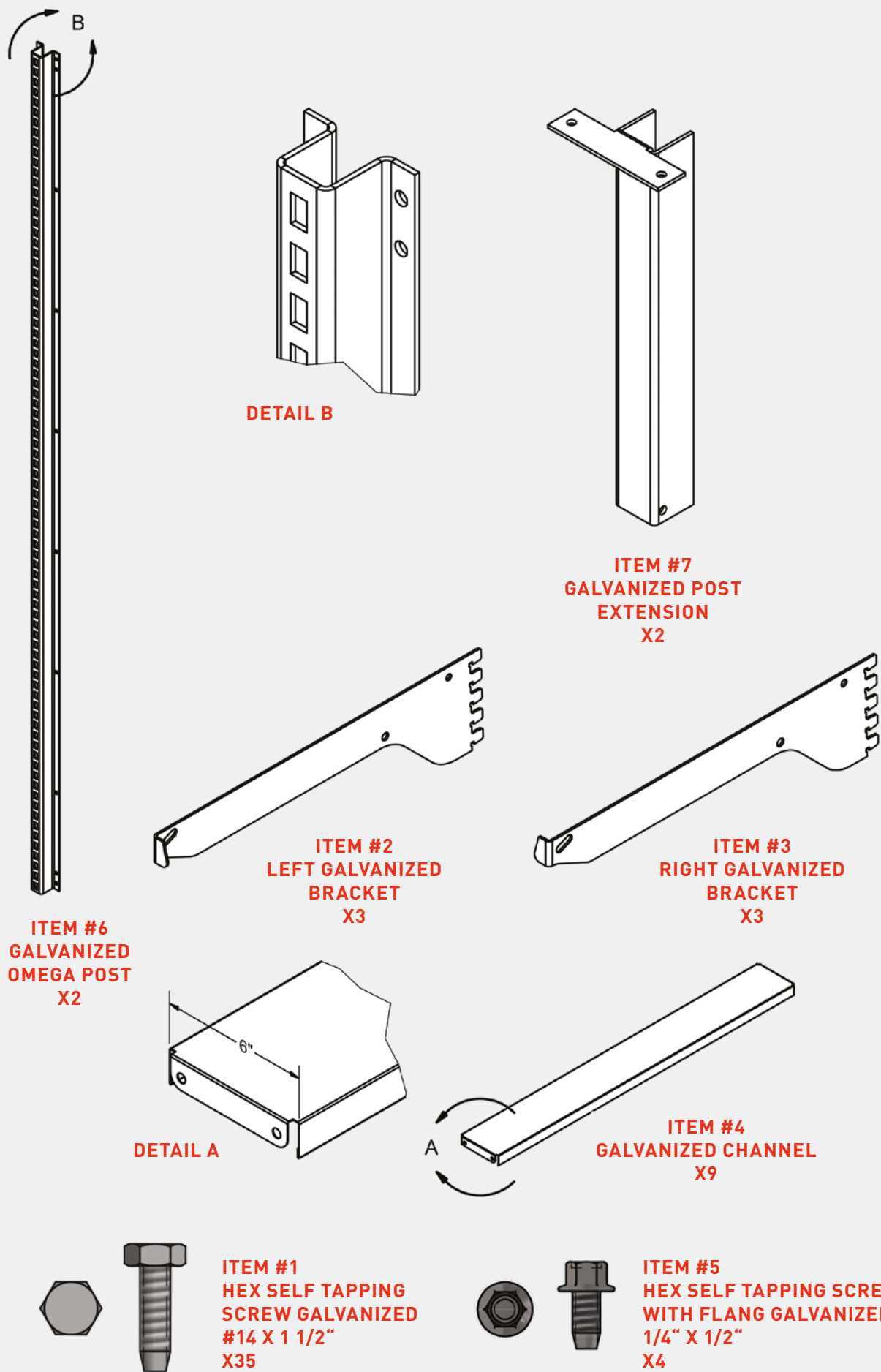

PARTS LIST OMEGA WALL		
ITEM	QTY	DESCRIPTION
1	35	TEK SCREW NO 14 X 1 1/2" LG GALVANIZED
2	3	LEFT BRACKET GALVANIZED
3	3	RIGHT BRACKET GALVANIZED
4	9	GALVANIZED CHANNEL
5	4	HEX SELF TAPPING SCREW WITH FLANG GAL 1/4" X 1/2"
6	2	GALVANIZED OMEGA POST 83 1/4"
7	2	GALVANIZED POST EXTENSION 12"
SYSTEM LOAD CAPACITY		
LOAD CAPACITY PER SECTION : 600 LB / LOAD CAPACITY PER SHELF : 300 LB		

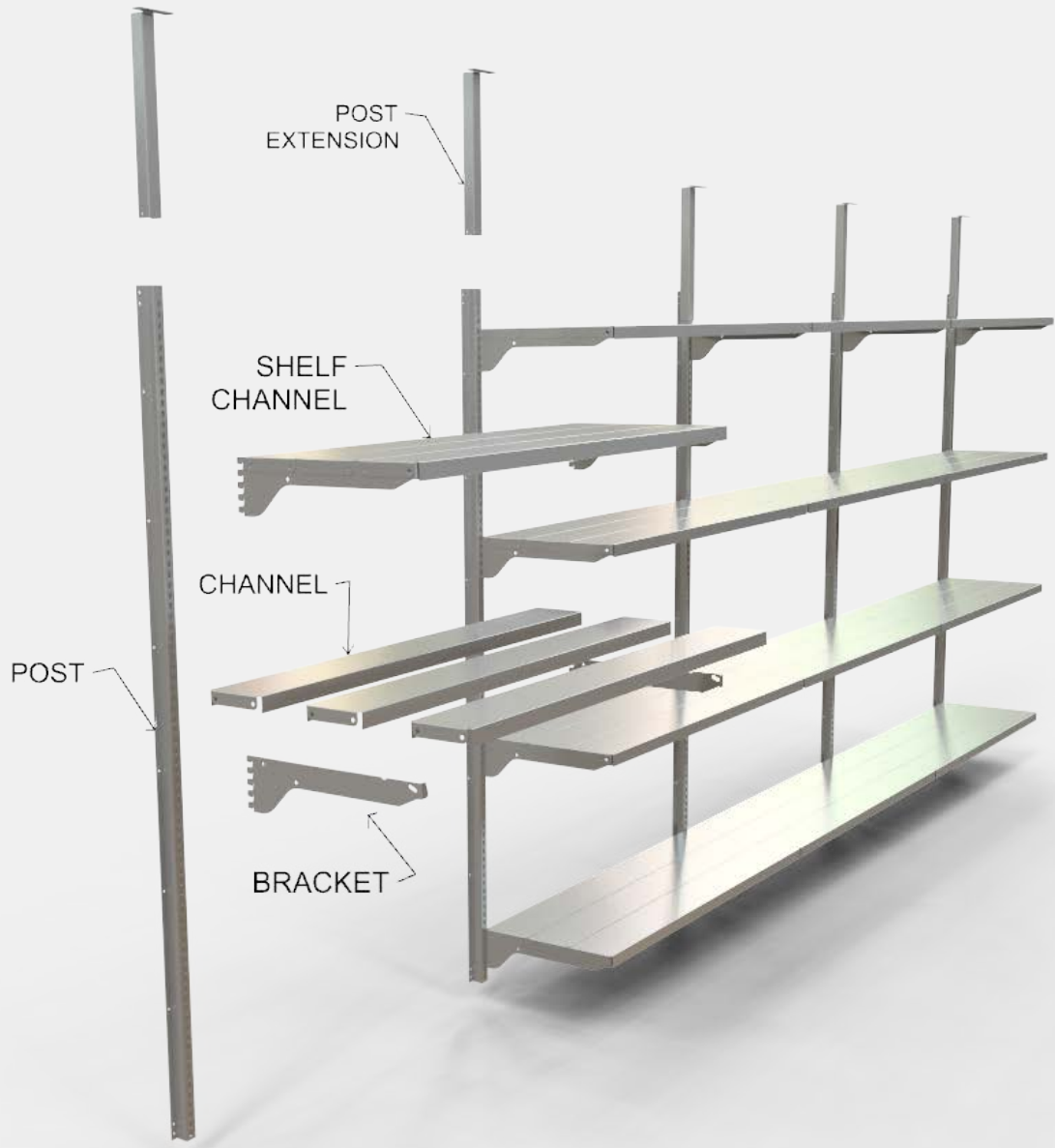

**NOTE:**  
THE INDICATED CAPACITIES ARE FOR THE SHELVES AND SUPPORT ONLY. IT'S THE OWNER'S RESPONSIBILITY TO ENSURE THAT THE STRUCTURE ON WHICH THE SHELVING IS INSTALLED IS STRONG ENOUGH TO HOLD THOSE SPECIFICATIONS.



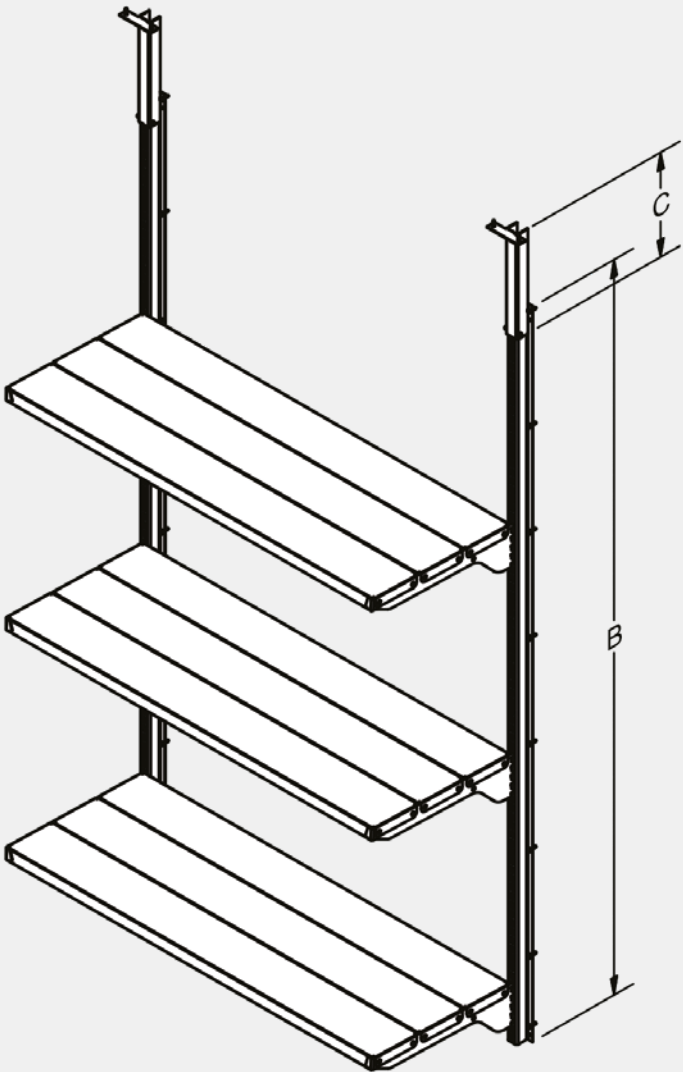

**STEP 1:**  
MARK AND MEASURE TO POSITION POSTS.

**STEP 2:**  
ADJUST THE LEVEL.  
**FIG.1**

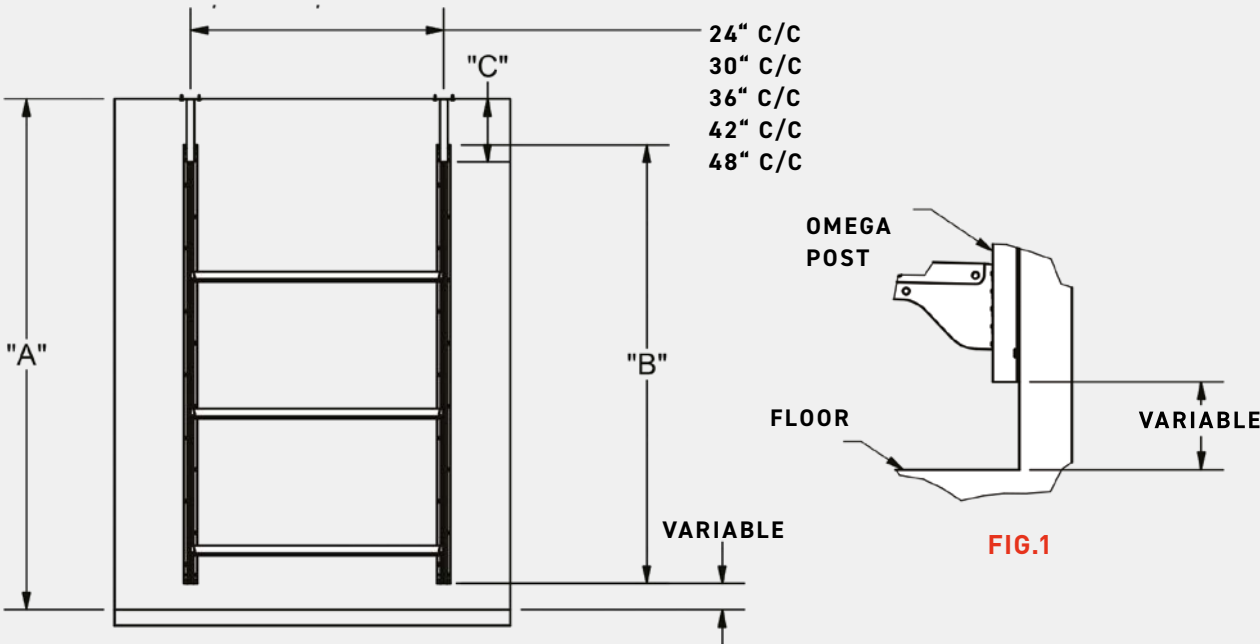

INFORMATION LIST				
ROOM HEIGHT "A"	POST LENGTH "B"	EXTENSION LENGTH "C"	USEFUL HEIGHT FOR SHELF	POST-EXTENSION OVERLAP
84	83.25	12	72	12
85	83.25	12	73	11
86	83.25	12	74	10
87	83.25	12	75	9
88	83.25	12	76	8
89	83.25	12	77	7
90	83.25	12	78	6
91	83.25	12	79	5
92	83.25	24	80	16
93	83.25	24	81	15
94	83.25	24	82	14
95	83.25	24	83	13
96	95.25	12	84	11.25
97	95.25	12	85	10.25
98	95.25	12	86	9.25
99	95.25	12	87	8.25
100	95.25	12	88	7.25
101	95.25	12	89	6.25
102	95.25	12	90	5.25
103	95.25	24	79	16.25
104	95.25	24	80	15.25
105	95.25	24	81	14.25
106	95.25	24	82	13.25
107	95.25	24	83	12.25
108	95.25	24	84	11.25
109	95.25	24	85	10.25
110	95.25	24	86	9.25
111	95.25	24	87	8.25
112	95.25	24	88	7.25
113	95.25	24	89	6.25
114	95.25	24	90	5.25
115	95.25	30	85	10.25
116	95.25	30	86	9.25
117	95.25	30	87	8.25
118	95.25	30	88	7.25
119	95.25	30	89	6.25
120	95.25	30	90	5.25

**FIG.1**

**STEP 3:**  
PLACE THE POST EXTENSION (ITEM#7) ABOVE THE OMEGA POST (ITEM#6). SCREW THE EXTENSIONS AGAINST THE CEILING WITH THE #14 X 1 1/2" L HEX SELF-DRILLING SCREWS (ITEM#1). THEN SCREW THE POST TO THE WALL. FINALLY PUT THE SCREWS (ITEM#6) AT THE BOTTOM OF THE EXTENSION ON THE POST.

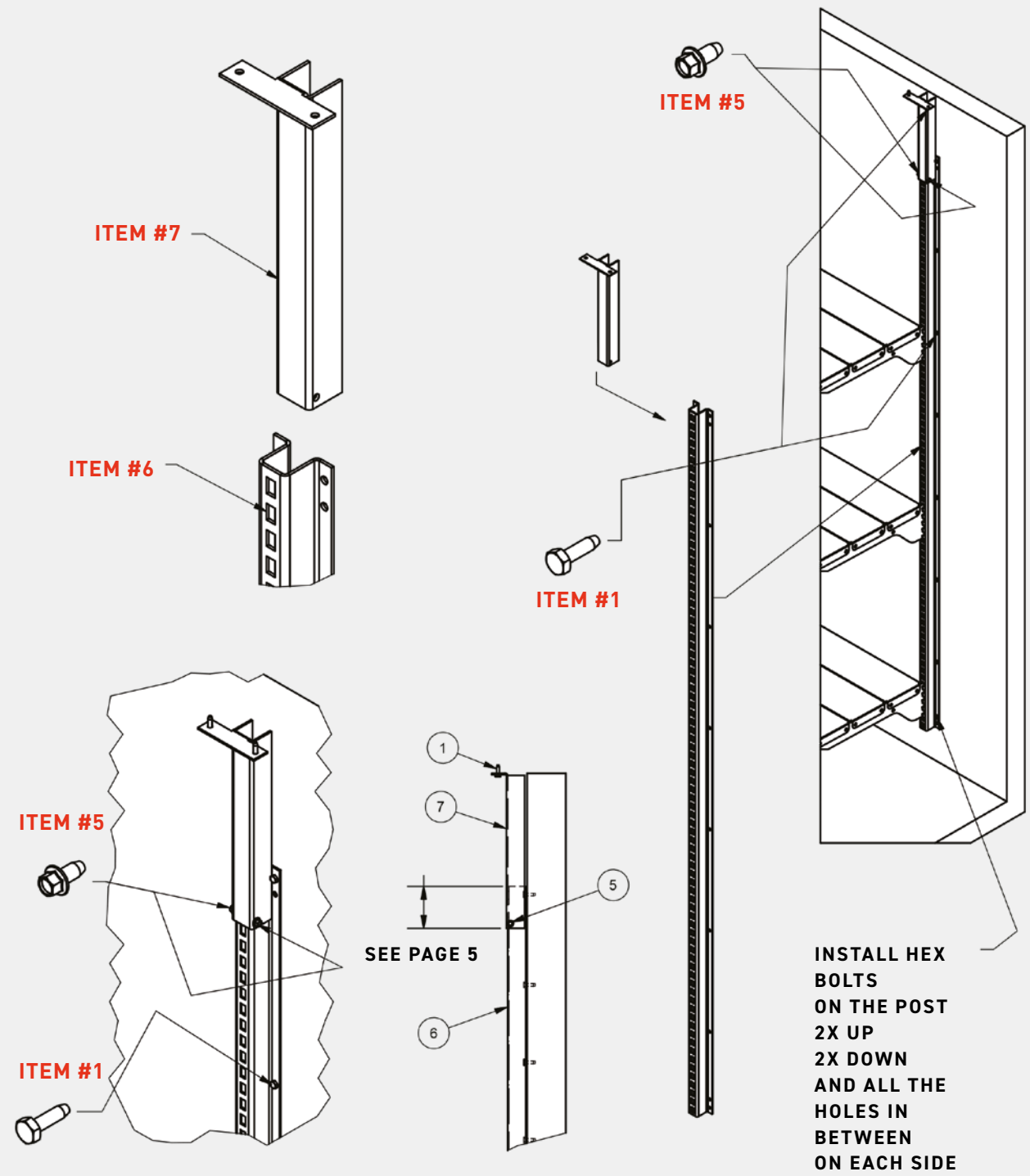

**STEP 4:**  
INSTALL THE BRACKETS (ITEM#3-4) AND THE INOX SLATS (ITEM#4) AT THE DESIRED HEIGHT.

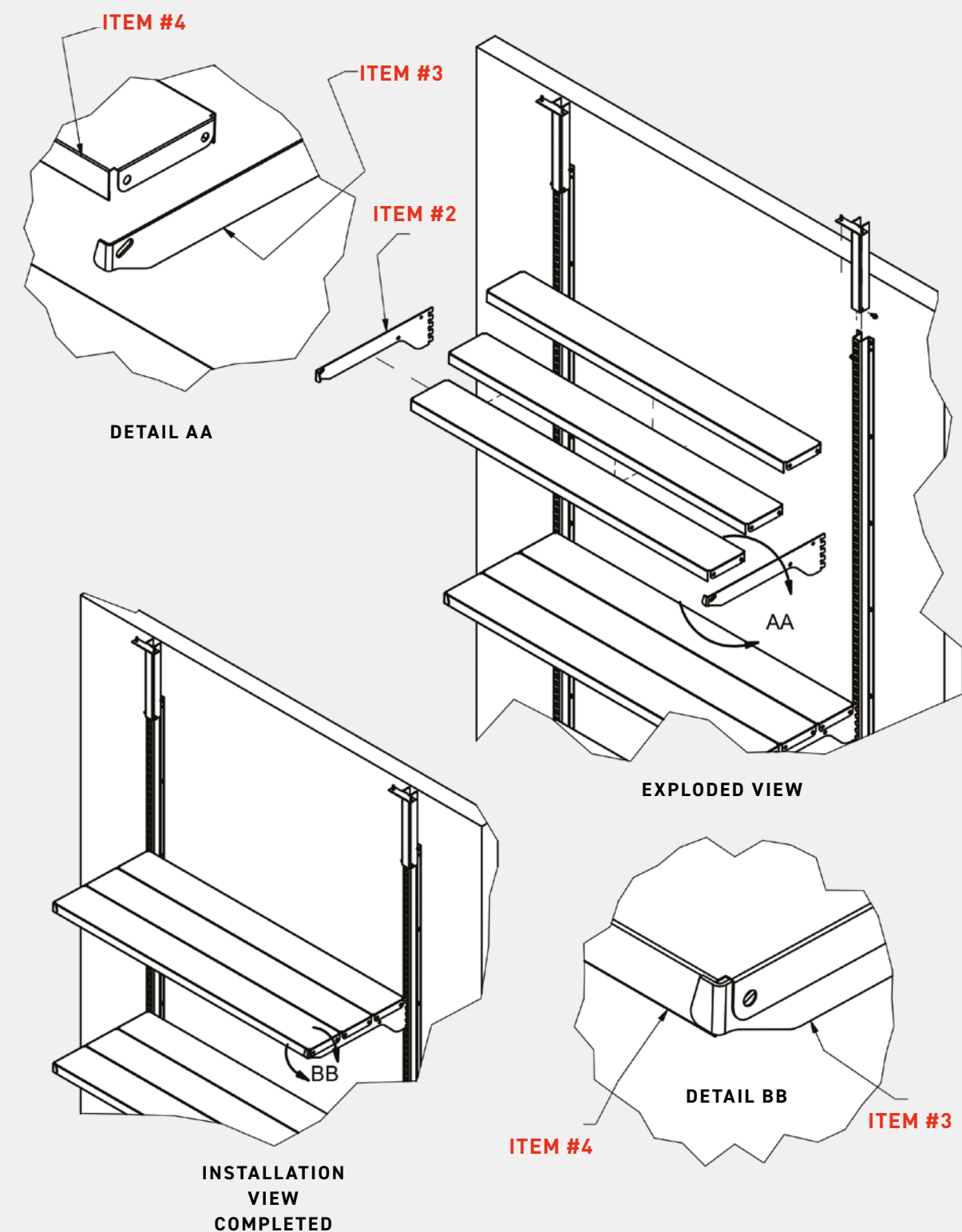



## WS LIGHT STORAGE

More discreet than our heavy storage systems, our Light Storage (WS type) shelving still knows how to make its place in terms of storage, industrial and commercial racking. It can replace our standard commercial shelves in retail stores, grocery stores or mini warehouses. This therefore makes it possible to place more massive goods, without the bulky appearance of a heavy storage system.

## END FRAMES

Width : 24"- 30"- 36"- 42"- 48"  
Height : 48"- 54"- 60"- 66", etc... ( à tous les 6")

## BEAMS

Length :  
48"- 54"- 60"- 66"- 72"- 78"- 84"- 90"- 96"- 102"- 108"- 114"- 120"  
Height: box 2", step 2 1/4" and 3"

Horizontal shelves = 20Ga. / Vertical beams = 16Ga.  
Beams = 14 Ga.

ETALEX



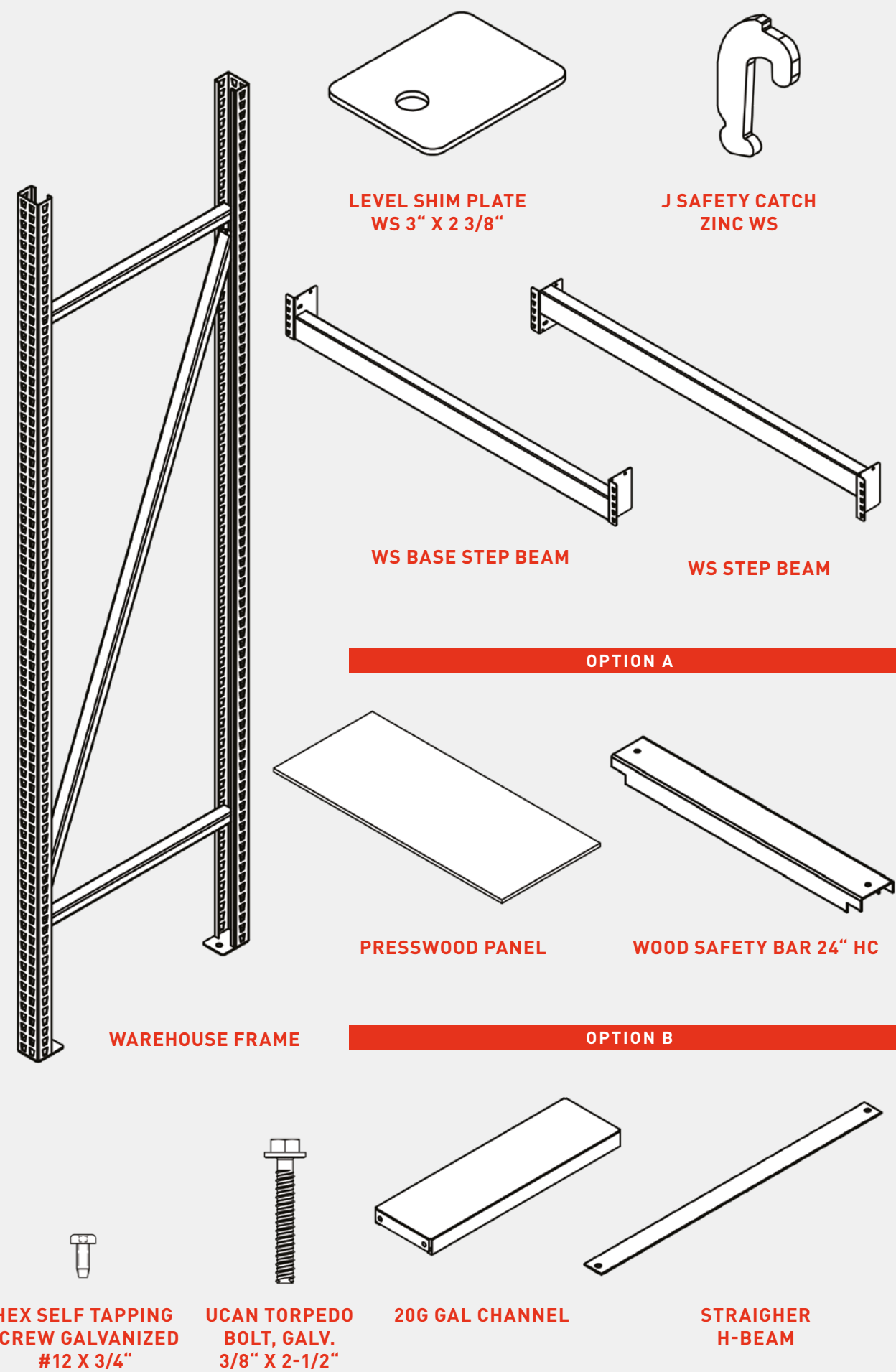

PARTS LIST LIGHT STORAGE WS			
ITEM	QTY	PRODUCT CODE	DESCRIPTION
1	2	03263(YZZ)	WAREHOUSE FRAME (YY") X (ZZ") WS
2	10	03225(HXXX)MB	H-BEAM (H") X (XXX") -1 5/8" + SUP-WS
3	6	01415XXYYH	PRESSWOOD (5/8")(XX") X (YY")
4	2	03225B(HXXX)MB	H-BEAM BASE (H") X (XXX") -1 5/8" + SUP-WS
5	12	401HC02(YY)	WOOD SAFETY BAR (YY") HC
6	20	401A00000A	SAFETY CLIP (1/8")
7	4	032000001	SHIM WS 3" X 2 3/8"
8	4	530ANCB0U375250	UCAN TORPEDO BOLT, GALV. 3/8" x 2-1/2"
9	48	0231106(YY)H	LATTE GAL-20G 1 7/16"x6"x(YY")
10	20	0239010(YY)	STRAIGHER H-BEAM
11	12	530VISAUTO12075	HEX SELF TAPPING SCREW GALVANIZED 12-3/4"

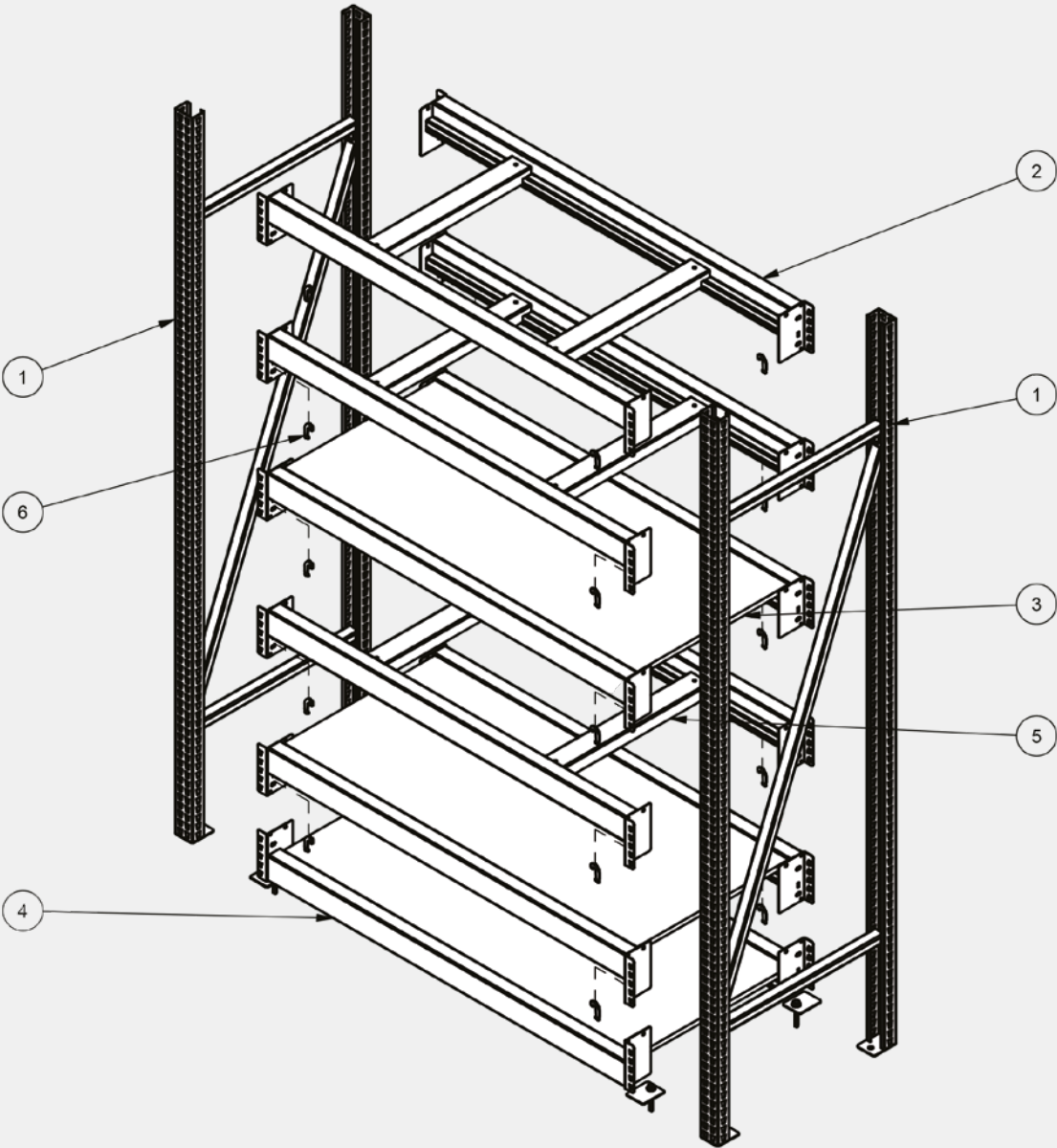

## ASSEMBLY

**STEP 1:**  
DRAW A GUIDE LINE ON THE FLOOR TO POSITION FRAMES. **(ITEM#1)**

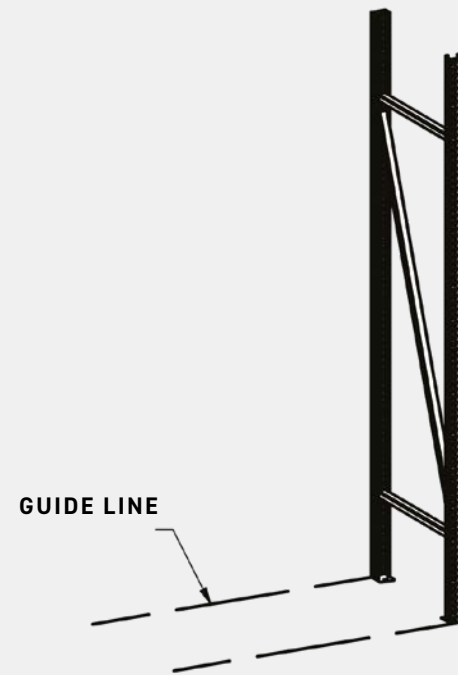

**STEP 2:**  
SECURE THE FRAMES, POSITION THE FIRST FRAME.

**STEP 3:**  
INSTALL THE BOTTOM LEVEL OF THE STEP BEAM ON THE FRAME **(ITEM#4)**.

**STEP 4:**  
INSTALL THE TOP LEVEL OF THE STEP BEAM ON THE FRAME. **(ITEM#2)**

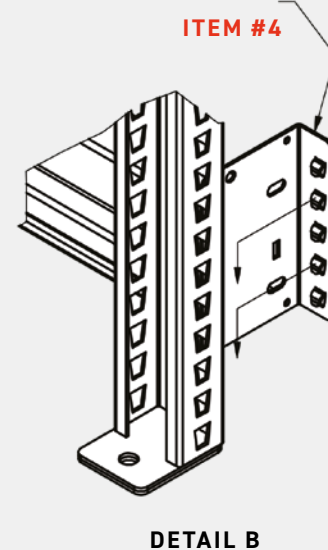
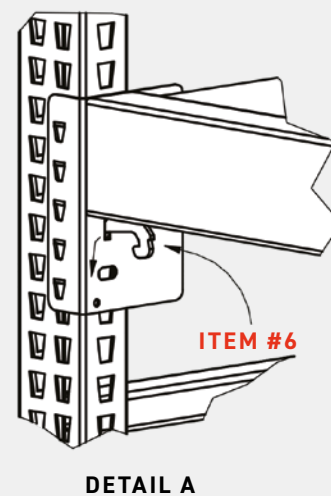
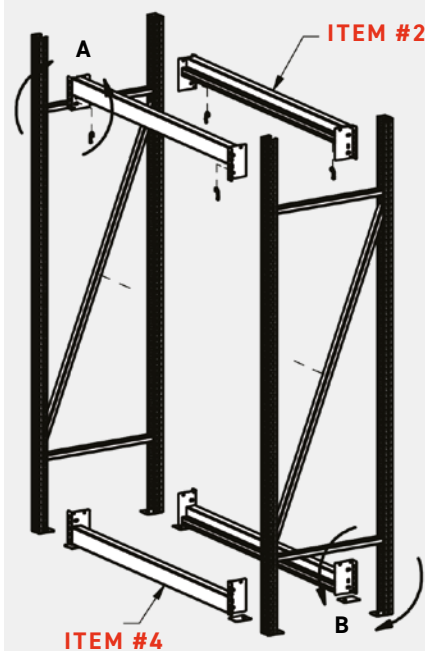

**STEP 5:**  
CHECK THE HEIGHT DIFFERENCE OF THE UPRIGHT FRAMES WITH A LASER LEVEL. THIS DIFFERENCE MUST NOT EXCEED L/240 TIMES THE HEIGHT OF THE EMPTY FRAME OR L/200 LOADED.

### EXAMPLE:

FOR AN UPRIGHT OF 120" (10 FT), THE HEIGHT DIFFERENCE MUST NOT EXCEED 1 IN, OR  $120"/240 = 1/2$  IN, DEPENDING ON THE CRITERION OF L/240. IF THE DISTANCE IS GREATER, PROCEED WITH LEVELING USING UPRIGHT SHIM (ITEM#7) APPLIED UNDER THE BASE OF THE UPRIGHTS FRAMES, AS TO HAVE THE BEST VERTICALITY. WHEN THE THICKNESS OF THE LEVELING PLATES EXCEEDS 1/2" ASSEMBLY MUST BE WELDED TOGETHER TO PREVENT DISPLACEMENT ON IMPACT.

**STEP 6:**  
WHEN YOU HAVE THE CORRECT HEIGHT DIFFERENCE, FIX THE UPRIGHTS TO THE GROUND USING CONCRETE ANCHORS **(ITEM#8)** THE ANCHORS MUST BE INSTALLED ON THE FRONT PLATE AND THE BACK PLATE.

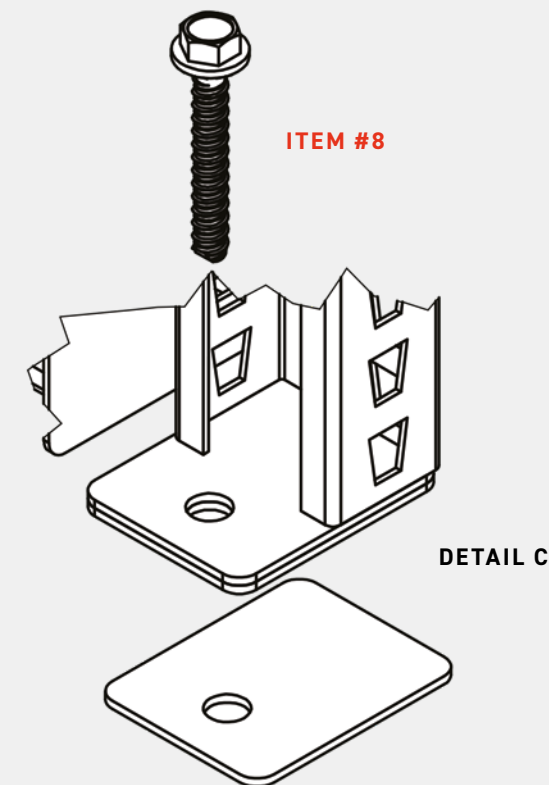

## ASSEMBLY

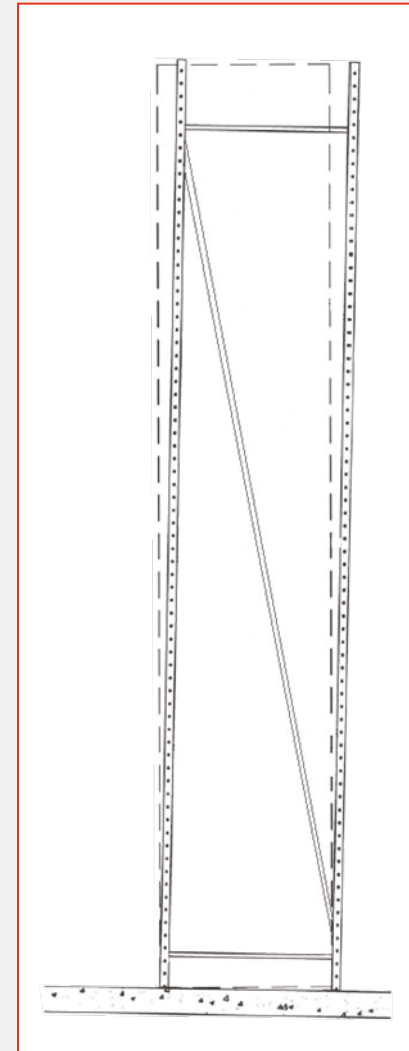

**STEP 7:**  
INSTALL THE STEP BEAM AT DESIRED HEIGHT.

Available widths :  
24"- 30"- 36"- 42" et 48"  
Available heights :  
48"- 54"- 60"- 66"- 72"- 84"- 90"- 96" et 102"

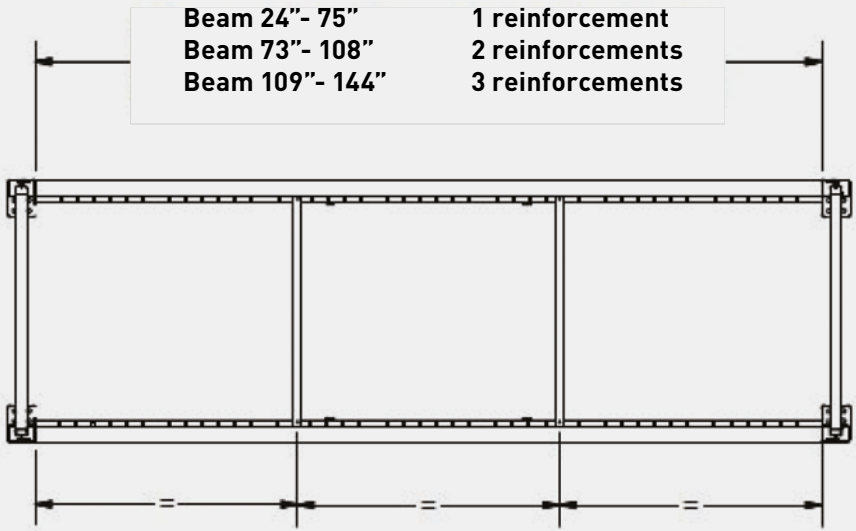
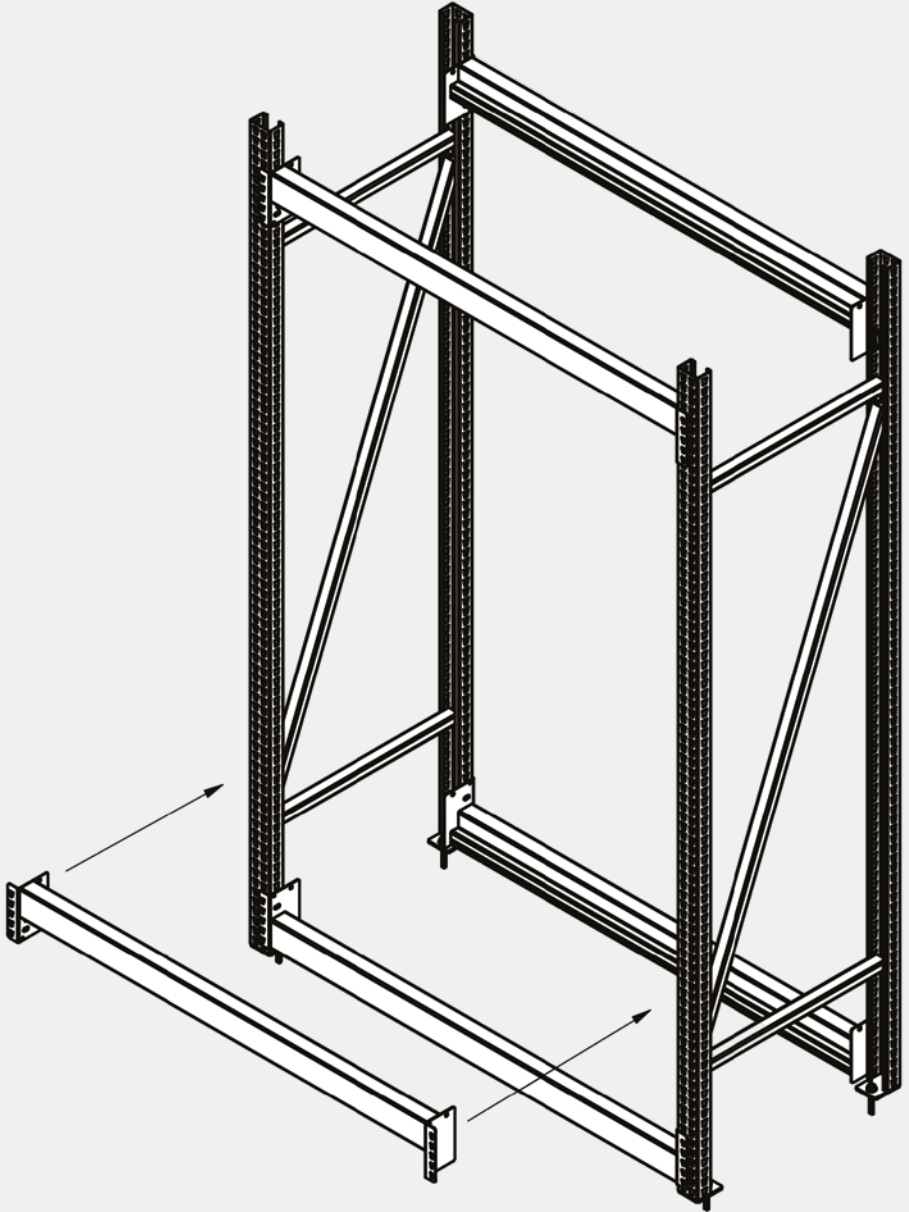
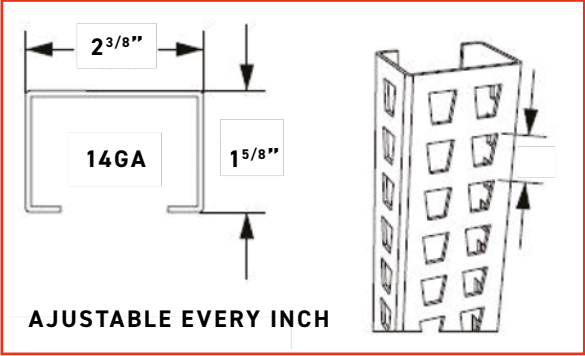

**REINFORCEMENT**

0239000XX - FOR H2 BEAM  
0239010XX - FOR H3 BEAM

XX = UPRIGHT DEPTH

**SELF TAPING SCREW**  
#12 X 3/4"  
AT BOTH ENDS  
530VISAUTO12075

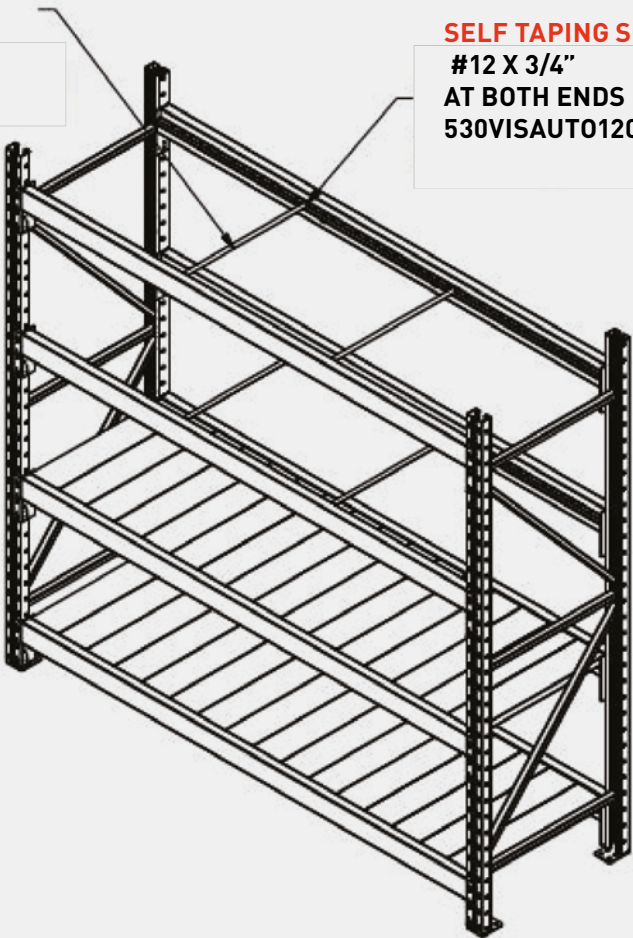



## ASSEMBLY

**STEP 8A:**  
INSTALL THE WOOD SAFETY BAR  
(ITEM#5) ON THE STEP BEAM (ITEM#2).

WOOD SAFETY BAR

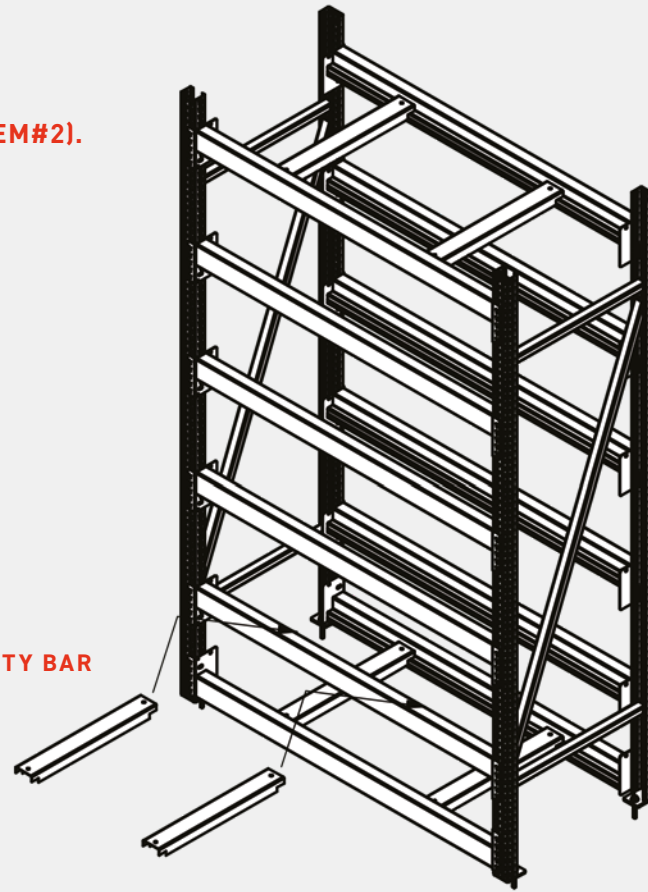

**STEP 8B: FOR GALVANIZED CHANNELS**  
INSTALL THE REINFORCEMENT BAR (ITEM#10)  
THE GALVANIZED LATTES 20GA CHANNEL (ITEM#9)  
ON THE STEP BEAM (ITEM#2 AND 4)

ITEM #10  
STRAIGHTER  
H-BEAM  
DETAIL 8B

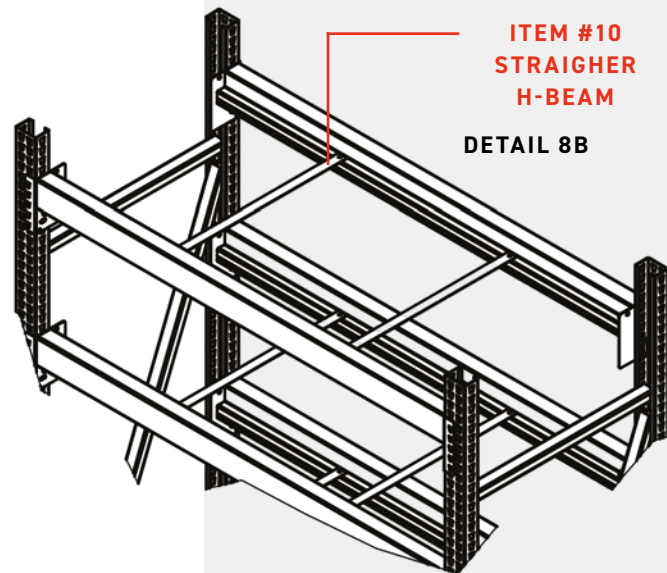

GALVANIZED  
CHANNELS

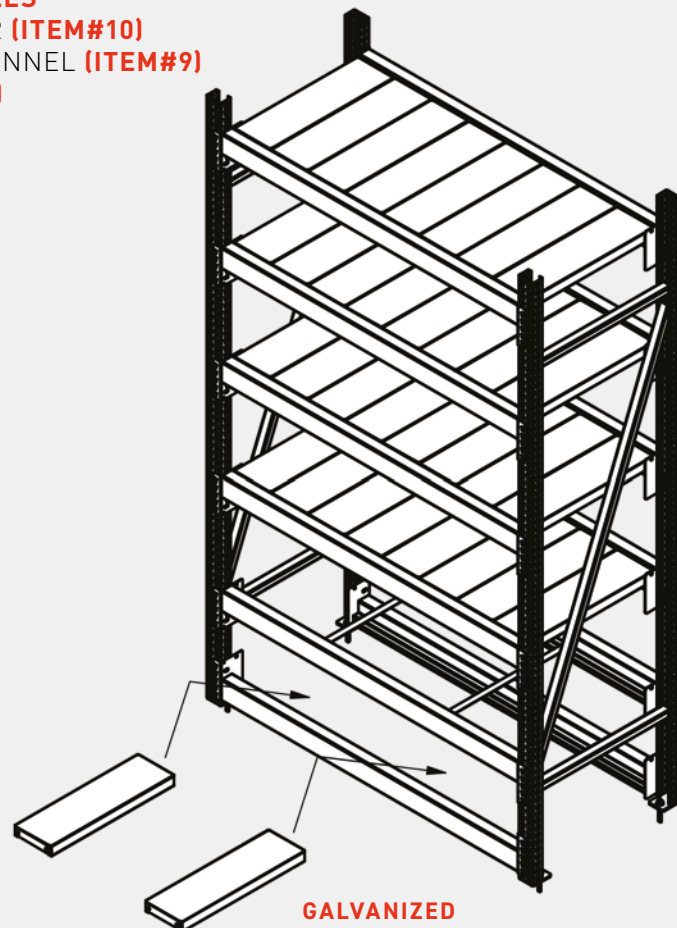

## ASSEMBLY

**STEP 9A: FOR PRESSWOOD PANELS**  
LAY THE PRESSWOOD PANELS (ITEM#3) ON THE WOOD SAFETY BAR HC  
(ITEM#5).

PRESSWOOD  
PANELS

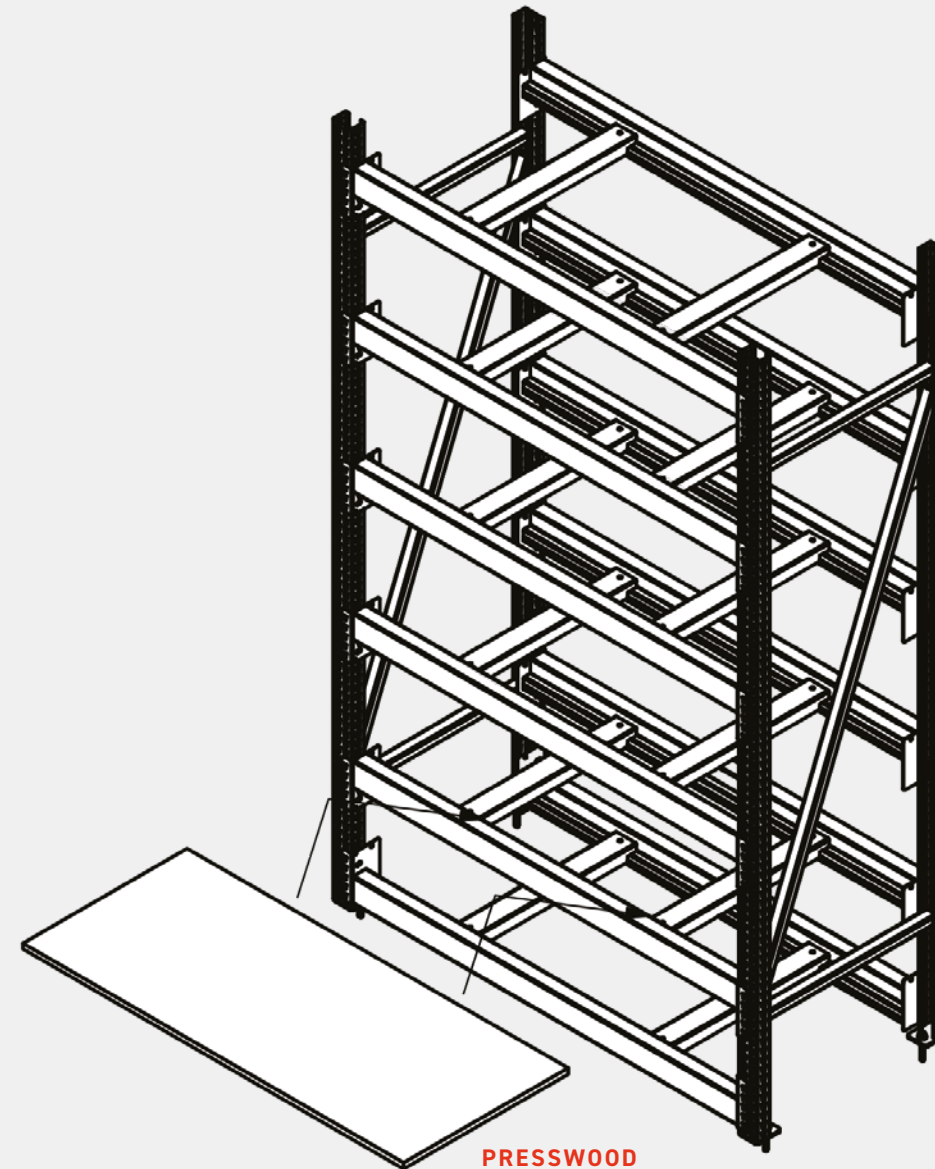



**WWW.ETALEX.CA**

## CONTACT US

### ANJOU PLANT

8501, Jarry Street East,  
Montreal, QC H1J 1H7

**T** 514 351-2000

**SF** 1 800 351-3125

### SAINT-BRUNO PLANT

1299, Marie-Victorin,  
St-Bruno, QC J3V 6B7

**T** 514 351-2000

**SF** 1 800 351-3125

### RAY-LAWSON PLANT

10251, Ray-Lawson,  
Anjou, QC H1J 1L6

**T** 514 351-2000

**SF** 1 800 351-3125



**FACEBOOK/ETALEX**



**LINKEDIN/ETALEX**



**YOUTUBE/ETALEX**

**MADE IN CANADA** 

